

## ADS 75.SI

doors - vertical section

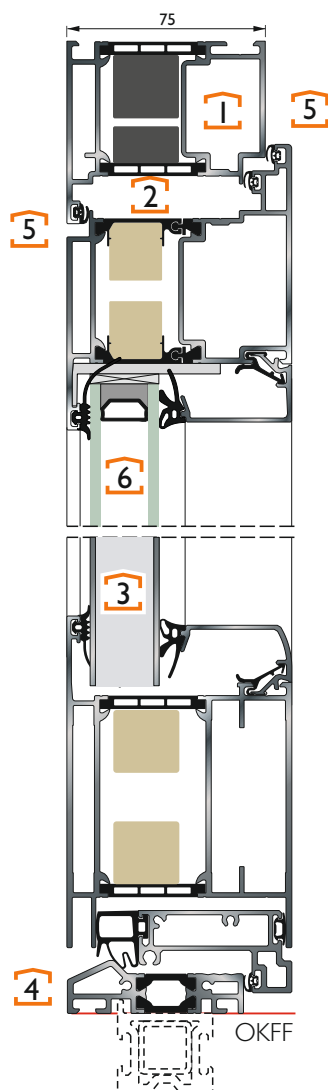

### 1 KONSTRUCTION

Aluminium profile frame thickness 75mm with straight lines.

### 2 THERMAL FOAM

In the middle of the frame profiles is thermal foam, which improves the thermal characteristics of the profile.

### 3 ALUMINIUM FILLINGS

with the core made of hard polyurethane foam has very good thermal characteristics.

### 4 HARDWARE

Quality three-dimensional adjustable hinges.

3 or 5-point locking of the leaf.

Various options for opening: outside opening, a fingerprint system,

### 4 INSULATING TRESHOLD

### 5 THREE SEALS ensure optimal tightness.

### 6 GLAZING

You can choose from a variety of thermal and acoustic insulated and safety glass.

A wide selection of ornaments and vitrages according to your wishes.

Finishing the glass with various foils, glass accessories, sandblasting etc.

### ALUMINIUM SURFACES

A powder-coated aluminum clads are environmentally friendly and provides excellent quality and durability of coloured surfaces. A wide range of colors from the RAL color chart, imitation wood decors and colors with a metallic appearance.

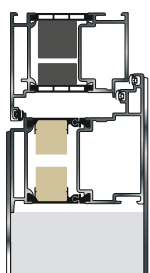

coating of aluminum  
on both sides overlap  
the door frame

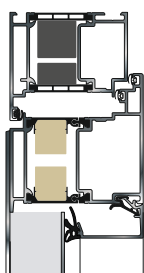

coating of aluminum  
on outer side overlap  
the door frame

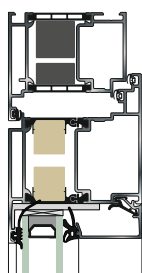

visible door frame -  
inside and outside

### Profile ADS 75.SI

$U_D = 0,81 \text{ W/m}^2\text{K}$  (coating of aluminum on both sides overlap  
the door frame - without cutouts for the glas)

$U_D = 1,2 \text{ W/m}^2\text{K}$  (coating of aluminum on outer side overlap  
the door frame - without cutouts for the glas)

## ADS 75B.SI

doors - vertical section

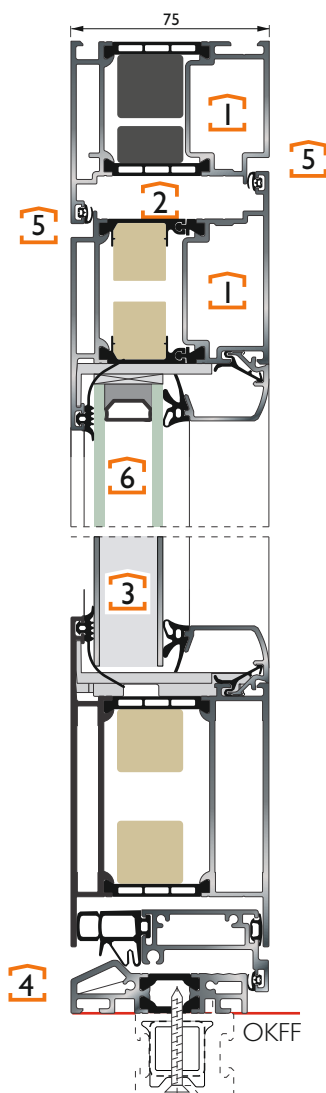

### 1 KONSTRUCTION

Aluminium profile frame thickness 75mm with straight lines.

### 2 THERMAL FOAM

In the middle of the frame profiles is thermal foam, which improves the thermal characteristics of the profile.

### 3 ALUMINIUM FILLINGS

with the core made of hard polyurethane foam has very good thermal characteristics.

### 4 HARDWARE

Quality three-dimensional adjustable hinges.

3 or 5-point locking of the leaf.

Various options for opening: outside opening, a fingerprint system,

### 4 INSULATING TRESHOLD

### 5 THREE SEALS ensure optimal tightness.

### 6 GLAZING

You can choose from a variety of thermal and acoustic insulated and safety glass.

A wide selection of ornaments and vitrages according to your wishes.

Finishing the glass with various foils, glass accessories, sandblasting etc.

### ALUMINIUM SURFACES

A powder-coated aluminum clads are environmentally friendly and provides excellent quality and durability of coloured surfaces. A wide range of colors from the RAL color chart, imitation wood decors and colors with a metallic appearance.

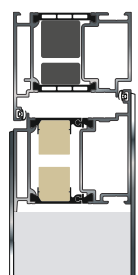

coating of aluminum  
on both sides overlap  
the door frame

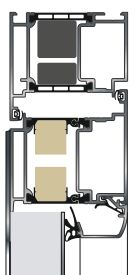

coating of aluminum  
on outer side overlap  
the door frame

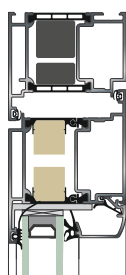

visible door frame -  
inside and outside

### Profile ADS 75B.SI

$U_D = 0,81 \text{ W/m}^2\text{K}$  (coating of aluminum on both sides overlap  
the door frame - without cutouts for the glas)

$U_D = 1,2 \text{ W/m}^2\text{K}$  (coating of aluminum on outer side overlap  
the door frame - without cutouts for the glas)

## ADS 95.SI

doors - vertical section

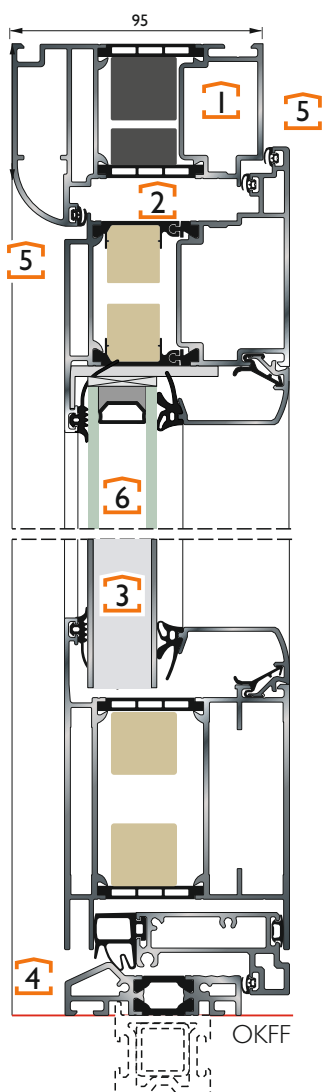

### 1 KONSTRUCTION

Aluminium profile frame thickness 95 mm with curved lines.

### 2 THERMAL FOAM

In the middle of the frame profiles is thermal foam, which improves the thermal characteristics of the profile.

### 3 ALUMINIUM FILLINGS

with the core made of hard polyurethane foam has very good thermal characteristics.

### 4 HARDWARE

Quality three-dimensional adjustable hinges.

3 or 5-point locking of the leaf.

Various options for opening: outside opening, a fingerprint system,

### 4 INSULATING TRESHOLD

### 5 THREE SEALS ensure optimal tightness.

### 6 GLAZING

You can choose from a variety of thermal and acoustic insulated and safety glass.

A wide selection of ornaments and vitrages according to your wishes.

Finishing the glass with various foils, glass accessories, sandblasting etc.

### ALUMINIUM SURFACES

A powder-coated aluminum clads are environmentally friendly and provides excellent quality and durability of coloured surfaces. A wide range of colors from the RAL color chart, imitation wood decors and colors with a metallic appearance.

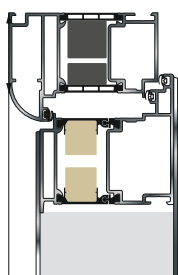

coating of aluminum  
on both sides overlap  
the door frame

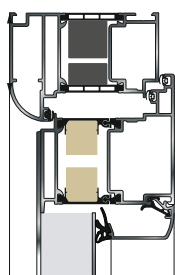

coating of aluminum  
on outer side overlap  
the door frame

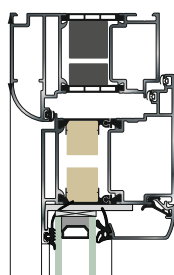

visible door frame -  
inside and outside

### Profile ADS 95.SI

$U_D = 0,81 \text{ W/m}^2\text{K}$  (coating of aluminum on both sides overlap  
the door frame - without cutouts for the glas)

$U_D = 1,2 \text{ W/m}^2\text{K}$  (coating of aluminum on outer side overlap  
the door frame - without cutouts for the glas)

## ADS 95AK.SI

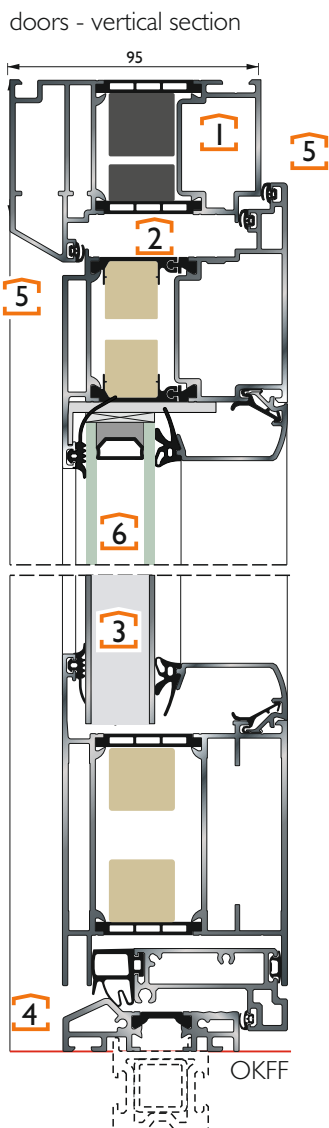

### 1 KONSTRUCTION

Aluminium profile frame thickness 95 mm .

### 2 THERMAL FOAM

In the middle of the frame profiles is thermal foam, which improves the thermal characteristics of the profile.

### 3 ALUMINIUM FILLINGS

with the core made of hard polyurethane foam has very good thermal characteristics.

### 4 HARDWARE

Quality three-dimensional adjustable hinges.

3 or 5-point locking of the leaf.

Various options for opening: outside opening, a fingerprint system,

### 5 INSULATING TRESHOLD

### 6 THREE SEALS ensure optimal tightness.

### 7 GLAZING

You can choose from a variety of thermal and acoustic insulated and safety glass.

A wide selection of ornaments and vitrages according to your wishes.

Finishing the glass with various foils, glass accessories, sandblasting etc.

### 8 ALUMINIUM SURFACES

A powder-coated aluminum clads are environmentally friendly and provides excellent quality and durability of coloured surfaces. A wide range of colors from the RAL color chart, imitation wood decors and colors with a metallic appearance.

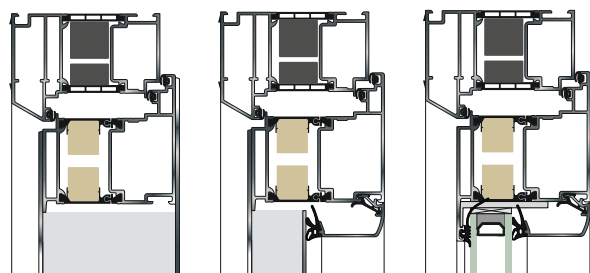

coating of aluminum  
on both sides overlap  
the door frame

coating of aluminum  
on outer side overlap  
the door frame

visible door frame -  
inside and outside

### Profile ADS 95AK.SI

$U_D = 0,81 \text{ W/m}^2\text{K}$  (coating of aluminum on both sides overlap  
the door frame - without cutouts for the glas)

$U_D = 1,2 \text{ W/m}^2\text{K}$  (coating of aluminum on outer side overlap  
the door frame - without cutouts for the glas)