

WOOD AND WOOD/ALUMINIUM ENTRANCE DOORS

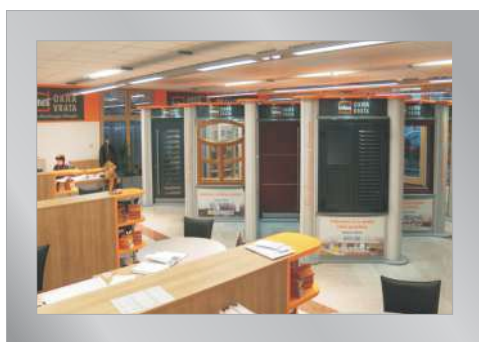

Custom wood windows and doors -

- ☐ Inles d.d. is a manufacturer of windows and doors with more than 75 years of experience.
- ☐ The legacy of Inles quality is built on hundreds of years of tradition in crafting woods.
- ☐ Inles products are known for quality and durability all over Europe. We are also known under the trade mark ISARHOLZ.
- ☐ Carefully selected materials and a technologically advanced manufacturing facility guarantee outstanding products for safety, durability, design and comfort.





☐ Inles offers only the highest quality windows and doors. We are recognized throughout the world. Most of our products we sell in the EU market and the markets of Asia, Africa, north and south America.

☐ We offer a variety of materials: wood, vinyl, aluminum or any combination of wood/aluminium, pvc/aluminium that will enhance the appearance and quality of your home.

☐ With Inles you can choose the materials to satisfy your taste.

*- Quality and advanced technology
for all architectural requirements.*



Wood and wood/alu doors



WOOD & WOOD/ALU DOORS

Entrance doors are your visitors' first contact with your home and people often say they are a mirror of your home. All Inles entrance doors are produced and designed with exceptional attention to detail. They will keep your home warm and protect you from unwanted visitors.

Series

**TREND ALPHA, TREND,
DELUXE, MODERN**
WOOD AND WOOD/ALU DOORS

Series

**ALPINE ALTHOLZ, TREND RUSTICO,
TREND LINE, TREND HBF,
TREND NOVO, KLASSICO ETA,
KLASSICO, ANTICO, RUSTICO,
NEOKLASSICO,
LOW-ENERGIE & PASSIV**
WOOD DOORS

WOOD AND WOOD/ALU DOORS (80)

TREND ALPHA

TREND ALPHA & TREND

The TREND Alpha 80 door series with flush double-sided leaf and concealed hinges offers a modern and attractive appearance.



HTA 944



HTA 264



HTA 100, Altholz Eiche, RG I



HTA 100



HTA 920A



HTA 264A



HTA 105



HTA 934

WOOD (68) AND WOOD/ALU DOORS (80/78)

TREND

TREND

The current series is characterized by elegant applications, recessed inox strips, and an extensive collection of refined handles and accessories. Indulge, enjoy, and choose and equip your own dream doors.



HT 911 / HSTT 400



HT 909 / HSTT 400



HT 265A



HT 264A / HSTT 400



HT 862A / HSTT 400



HT 863A / HSTT 400



HT 867 / HSTT 400



HT 887A / HSTT 400

WOOD DOORS (68/94)

ALPINE ALTHOLZ

ALPINE ALTHOLZ

ALPINE entrance doors combine modern design with the timeless elegance of natural wood.

The exterior is treated with aged wooden panels in a grayish or clear tone, giving the doors an authentic rustic touch.

The interior is made of spruce, larch, or oak wood. The surface can be only primed, and a full range of opaque color shades is available, along with a limited selection of translucent stains from our color chart.



HTF 101



HTF 100



HTF 102A



HTF 103 Q



HTF 100 Q



HTF 102B

WOOD DOORS (68/95)

TREND RUSTICO

TREND RUSTICO

This collection shows the natural wood oak with his most valuable and natural sort. Creative are the glass combinations, handles and applications.

Option: Trend Rustico wooden door frame with aluminum shell.



HTR 107



HTR 106A



HTR 105



HTR 103



HTR 103A



HTR 102A



HTR 106B / HSTT 400
with aluminum coating on the outside of the frame

WOOD DOORS (68)

TREND LINE

TREND LINE

The base of the door, frame and wing is available in any colors and tree species: spruce, pine, larch, oak and meranti.

On the outer side the wings are made of solid battens aligned with the door frame to crate a 3D look of larch or oak wood. The surface of the battens is only possible as oiled.



HTL 100 / HSTT 400



HTL 103



HTL 268



HTL 269



HTL 105



HTL 272



HTL 270

WOOD DOORS (68)

TREND HBF

TREND HBF

The combination of rustikal and modern look/design gives this collection a whole special charm and creative effect.



HBF 906

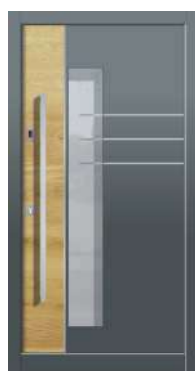

HBF 919A



HBF 894



HBF 91 1A / HSTT 400



HBF 266B



HBF 123



HBF 845 / HSTT400

WOOD (68) AND WOOD/ALU DOORS (80/78) DELUXE/ MODERN

Selection of door models.



HD 945 / HSTT 400



HD 875C



HD 801A / HSTT 400



HD 852A



HD 168



HM 134B



HM 180



HM 133A



HM 875C



HM 170

LOW-ENERGIE (68/95) & PASSIV DOORS (98)

LOW-ENERGY WOODEN DOORS

Wooden entrance doors made of Ferro Klassikplus rolling, 95 mm thick, achieve excellent thermal permeability of the door, $U_d=0.67 \text{ Wm}^2/\text{K}$. All door models from the Modern series are also available in this version.

H 68/95

**LOW
ENERGIE**

HT 100
FERRO KLASSIKPLUS

| 68/95 Ud (Wm ² /K) |
|---------------------------------|
| H 0,67* |

Explanation
* applies to soft woods,
for door dimensions 1100 x 2100 mm
and a leaf without a glass cutout.

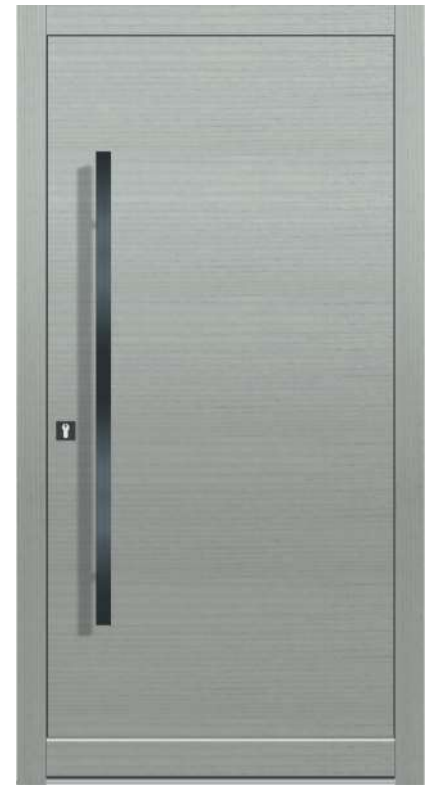

HT 100



PASSIV WOODEN DOORS

Certified wooden doors made of rolling of 98 mm thickness are suitable for low-energy and passive buildings.

H 98 PASSIVE

HT 264
FERRO PASSIV

Ud = 0,80 W/m²K



WOOD DOORS (80)

TREND NOVO

TREND NOVO

Wooden entrance door with a glazing batten on the outside and inside.

The TREND NOVO 80 door series in flush execution creates special aesthetics for your entrance.



HTN 102



HTN 104



HTN 102



HTN 103



HTN 101



HTN 103

WOOD DOORS (80)

CLASSICO ETA

KLASSICO ETA

Wooden entrance door made of solid wood with a glazing batten on the outside and inside.

The CLASSICO ETA door series in flush execution creates special aesthetics for your entrance.



HCKE 402



HCKE 401



HCKE 400



HCKE 407



HCGE 051



HCKE 401P

WOOD DOORS (68)

KLASSICO/ NEOKLASSICO

Selection of door models.



HCK 424/HSTC 400



HCK 419/OL 101



HCK 400



HCK 413/HSTC 413A



HCK 418



HCN 708



HCN 714



HCN 739



HCN 711



HCN 709

WOOD DOORS (68)

ANTICO/ RUSTICO

Selection of door models.



*HCA 611



HCA 610



*HCA 612



HCA 607



HCA 603
glass SG 317

Explanation:
models *HCA 611 and *HCA 612
are only available in shades RGI, RIÖ1,
REÖ1, RF200, RL200, RE200
and in all covering RAL colors.



HCR 545



HCR 503



HCR 535;
glass SG 316



HCR 517



HCR 514

WOOD

- ☐ You can choose from the following species of wood: spruce, pine, larch, oak and meranti.
- ☐ The wood meets the RAL quality requirements according to EN 942
- ☐ The moisture content of the wood is controlled and amounts to 13 +/- 2%.
- ☐ Wood is stored in regulated air humidity warehouse, which prevents cracking and other defects related to inadequate moisture content in the wood.



WOOD PROFILES

- ☐ Wood frame and leaf profiles with a thickness of 68, 80 mm.
- ☐ The profiles are three layers of wood joined together using waterresistant D4 adhesive according to the EN 204 and EN 14257 standards.
- ☐ The mullion of the door leaves of the CLASSIC range include aluminium and steel stabilisers to prevent the leaf bending.

HARDWARE

- ☐ Quality three-dimensional adjustable standard Baka PROTECT 4010 3D FD hinges (HH 68) and concealed hinges Tectus TE 540 3D (HH80).
- ☐ 3 or 5-point locking of the leaf.
- ☐ Various options for opening: outside opening, a fingerprint system, electrical opening etc.

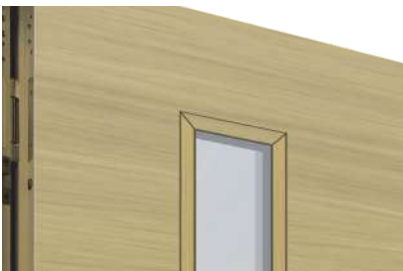

GLAZING

- ☐ You can choose from a variety of thermal and acoustic insulated and safety glass.
- ☐ A wide selection of ornaments and vitrages according to your wishes.
- ☐ Finishing the glass with various foils, glass accessories, sandblasting etc.

SURFACE TREATMENT

- ☐ You will surely find a colour shade to your taste from our wide range of various coatings.
- ☐ Optional two-coloured version.





VIEW FROM OUTSIDE



VIEW FROM THE INSIDE



Opening the door with dLine Fingerprint



Handle with an integrated Fingerprint reader dLine



Handle with an integrated LED light



LED light

CROSS SECTIONS

WOOD/ALUMINIUM ENTRANCE DOORS **INO-HAH**

with aluminum cladding
thickness **80** mm

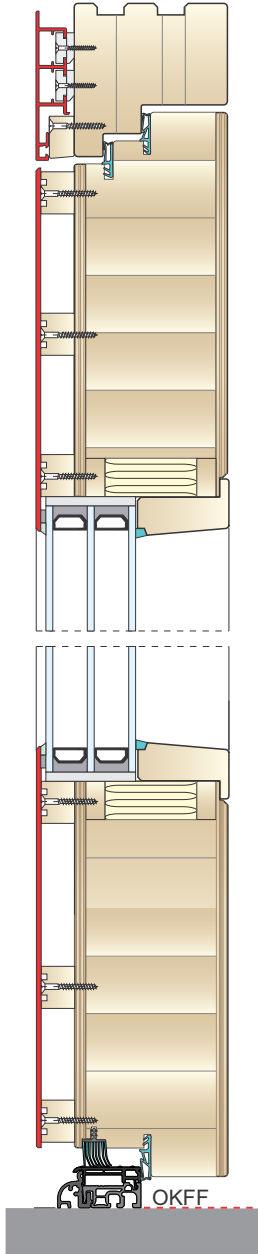

Series **TREND ALPHA**

with aluminum cladding
thickness **80/78** mm

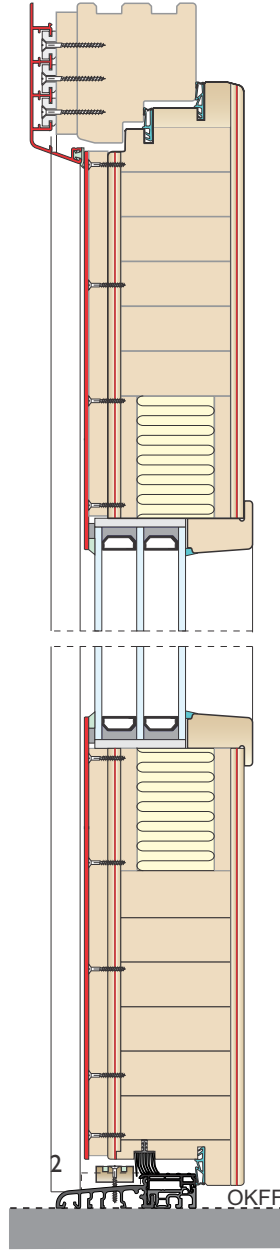

Series **TREND, DELUXE
MODERN**

| | | | |
|----------------------|--|---|--|
| Wood thickness 68 mm | <p>STANDARD VERSION ANGULAR EDGES glazing bar</p> | <p>ADDITIONAL OFFER PROFILED EDGES glazing bar</p> | <p>ADDITIONAL OFFER ROUNDED EDGES glazing bar</p> |
| | | | |
| | | | |

WOOD ENTRANCE DOORS INO-HH

Frame with aluminum cladding

thickness 80/ 80 mm

thickness 80/ 80 mm

thickness 68/ 95 mm

wood- thickness 68/ 95 mm

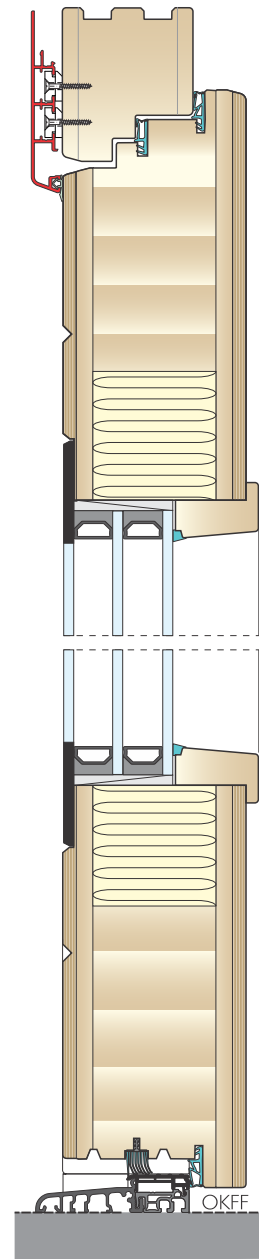
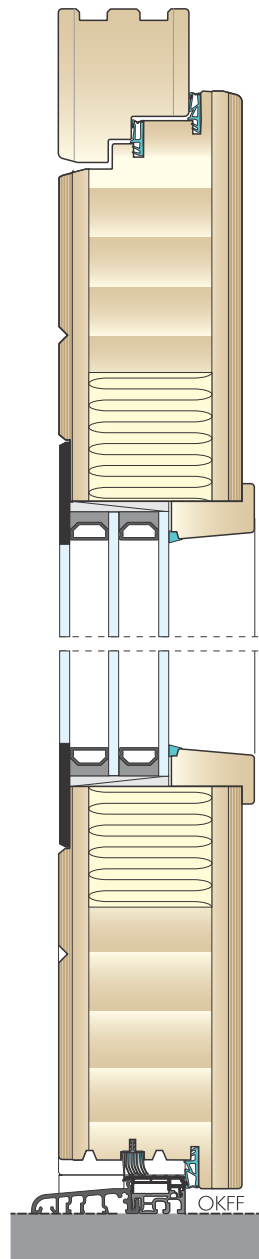
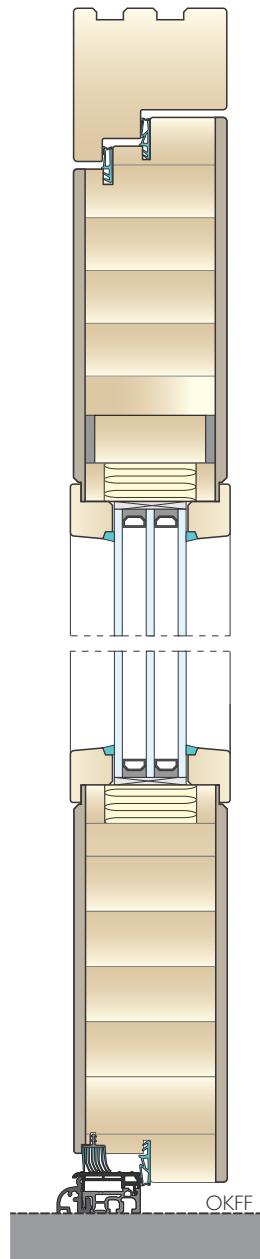
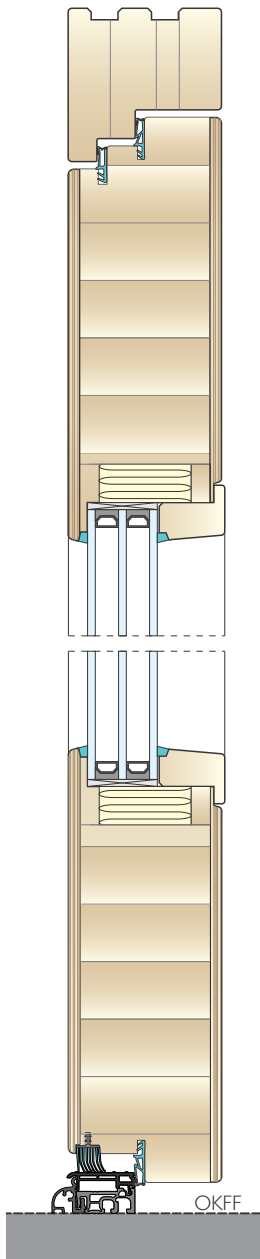

Series TREND ALPHA

Series TREND NOVO

Series TREND RUSTICO

Series TREND RUSTICO

WOOD ENTRANCE DOORS **INO-HH**

thickness 68/ 68-95 mm

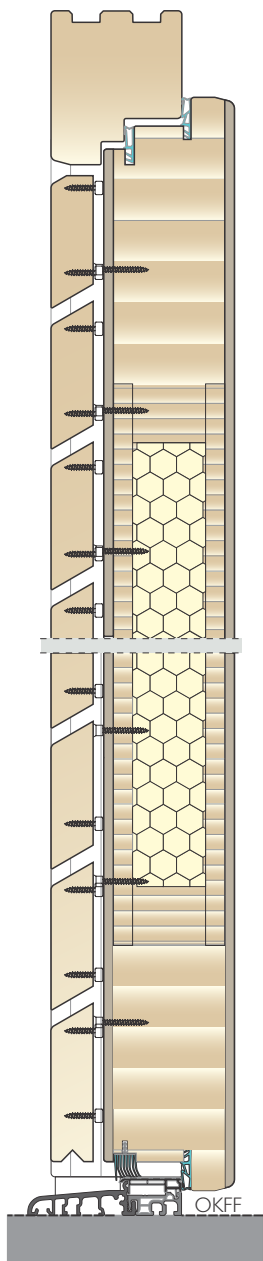

Series **TREND LINE**

thickness 68/ 68 mm

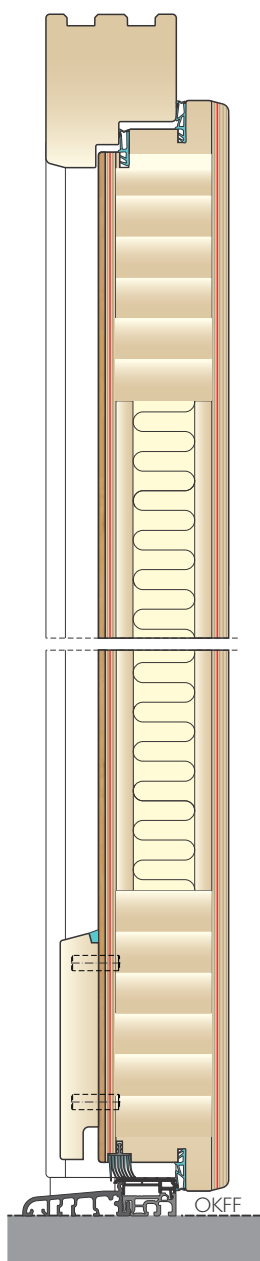

Series **TREND HBF**

thickness 68/ 68 mm

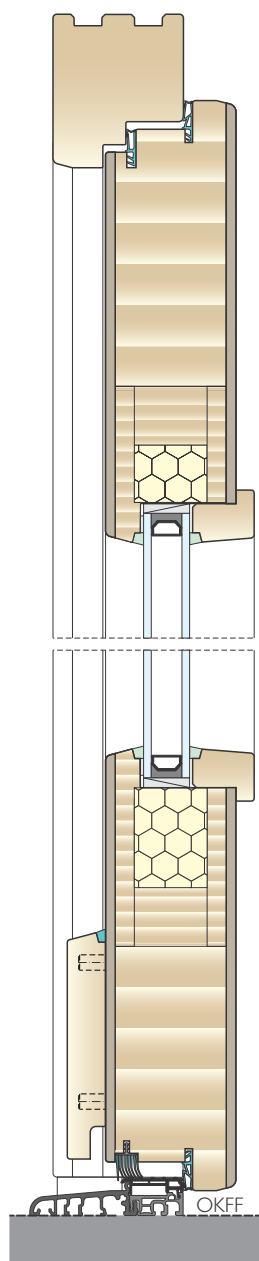

Series **TREND**

thickness 68/ 68 mm

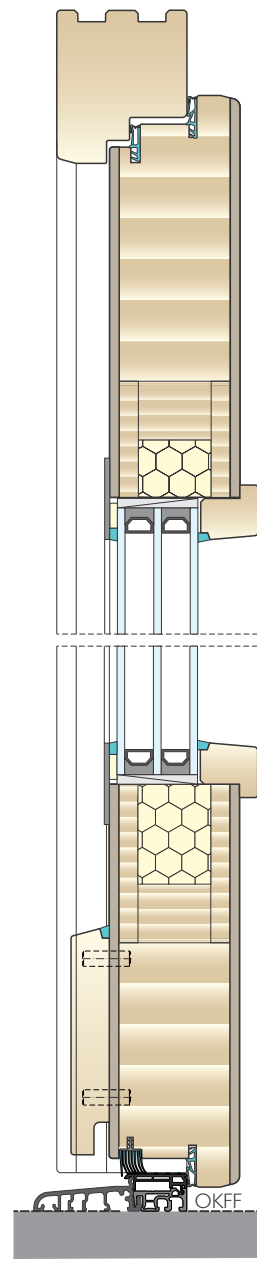

Series **DELUXE**

WOOD ENTRANCE DOORS **INO-HH**

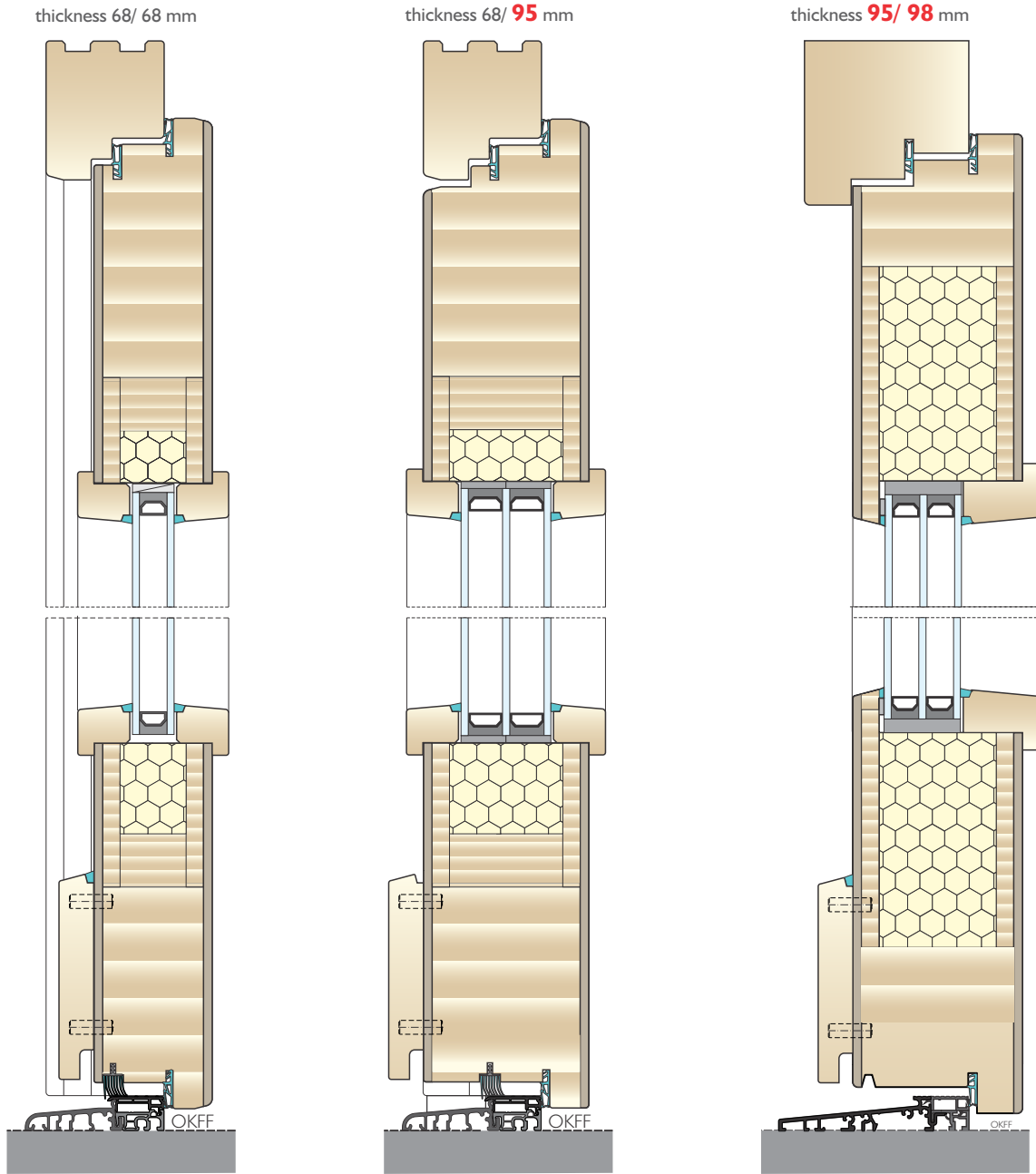

Series **MODERN**

Model **TREND, HT 100**
Series **MODERN**

LOW ENERGY

Model **TREND, HT 264**

PASSIVE

CROSS SECTIONS

WOOD/ALUMINIUM ENTRANCE DOORS **INO-HAH**

Solid wood
thickness 68 mm

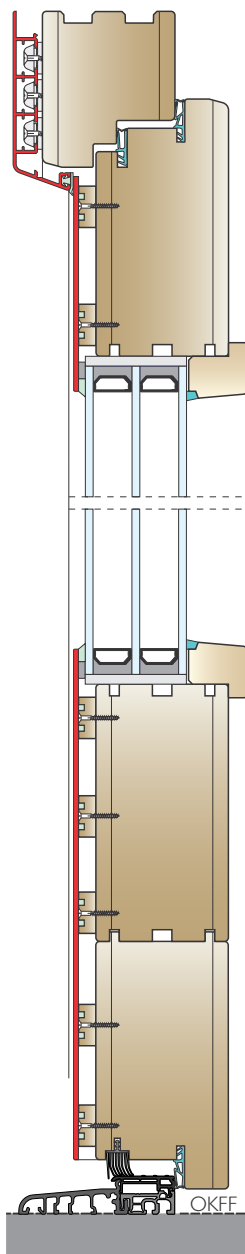

Series **KLASSICO**
(Due to technical reasons not
all models are available.)

WOOD ENTRANCE DOORS **INO-HH**

Solid wood
thickness 80/ 80 mm

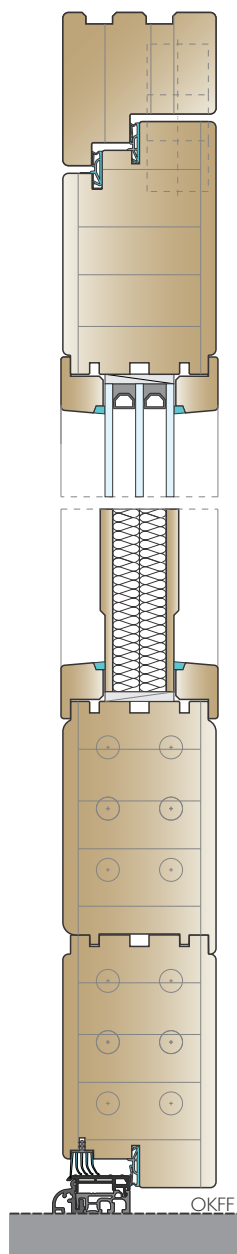

Series **KLASSICO ETA**

Solid wood
thickness 68/ 68 mm

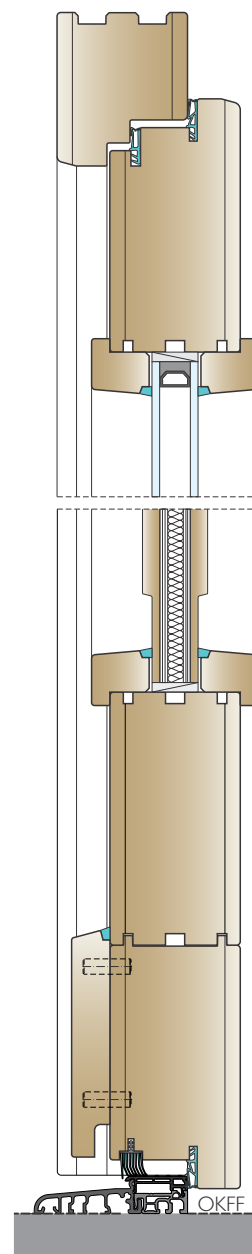

Series **ANTICO,
RUSTICO, KLASSICO,
NEOKLASSICO**

WOOD ENTRANCE DOORS **INO-HH**

STANDARD VERSION
ANGULAR EDGES
 (glazing bar, weatherboard)
BKV 80 TB threshold

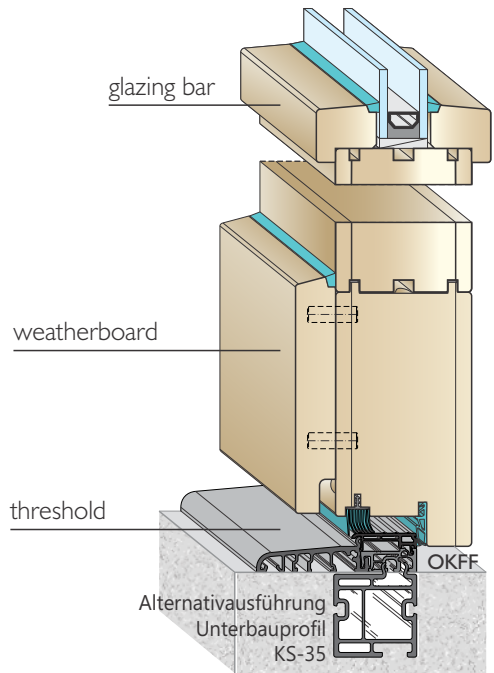

STANDARD VERSION HH 80
BKV 40 TB threshold

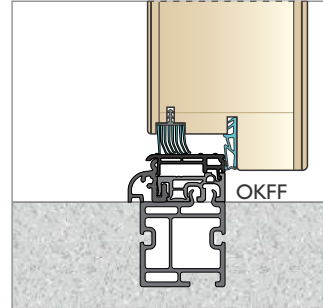

ADDITIONAL OFFER HH 80
BKV 80 TB threshold

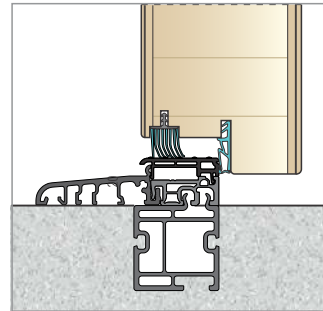

ADDITIONAL OFFER
 (glazing bar, weatherboard)
AV-02 threshold

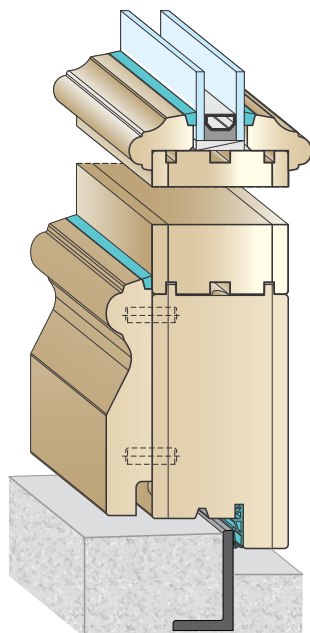

ADDITIONAL OFFER
 (glazing bar, weatherboard)
AV-07 threshold

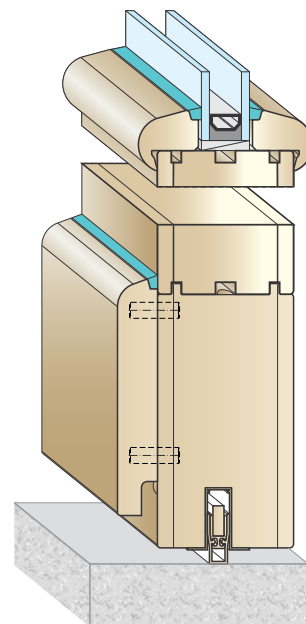

GLAZING

Ornamental glass

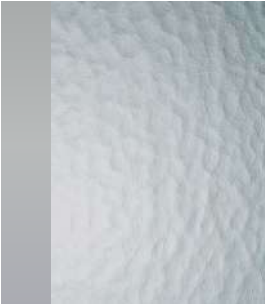

Kathedral K. WHITE



Chinchilla white

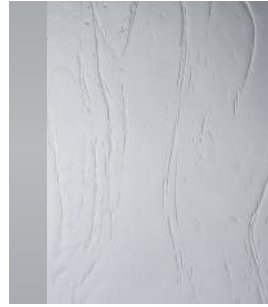

Gothic white

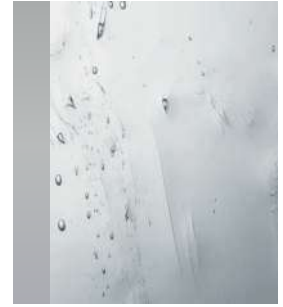

Altdeutsch K white

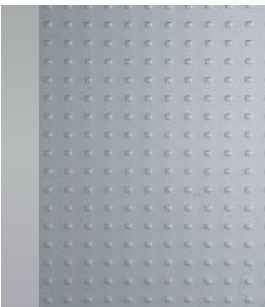

Mastercarre white



Masterligne white

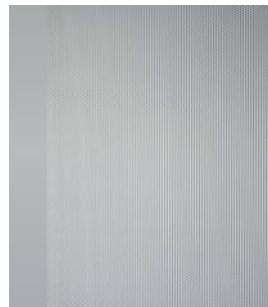

Masterpoint white

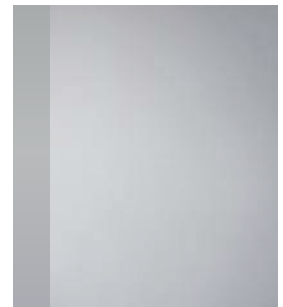

Satinato white



Silk white

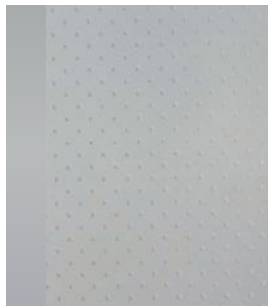

Pave white

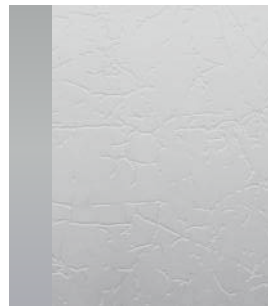

Uadi white



Nebulosa white

THERMAL INSULATING GLASS

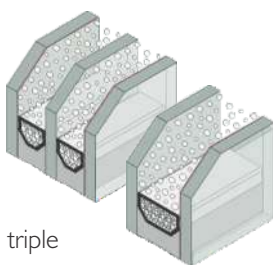

triple

twice

SANDBLASTED GLASS

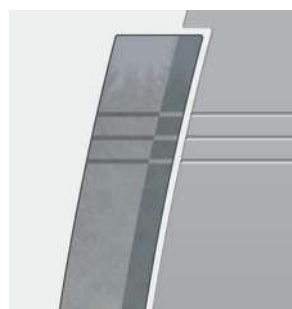
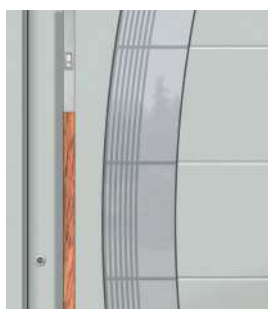

HANDLES

| | | | | | | |
|---|--|--|---|--|---|--|
| <p>Stainless steel - matte</p> <p>310 036 L=1000 mm</p> <p>310 037 L=1200 mm</p> <p>310 038 L=1400 mm</p> <p>310 039 L=1500 mm</p> <p>310 040 L=1600 mm</p> | <p>Stainless steel - matte</p> <p>ZAE 66 L = x</p> | <p>Stainless steel - matte</p> <p>314 585 L=400 mm</p> <p>314 586 L=800 mm</p> <p>314 597 L=1200 mm</p> <p>314 598 L=1600 mm</p> <p>316 847 L=1800 mm</p> <p>314 599 L=2000 mm</p> | <p>Stainless steel - matte</p> <p>310 017 L=400 mm</p> <p>310 019 L=800 mm</p> <p>310 021 L=1200 mm</p> <p>310 024 L=1500 mm</p> <p>310 025 L=1600 mm</p> <p>310 026 L=1800 mm</p> <p>310 027 L=2000 mm</p> | <p>Stainless steel - matte with cutout for reader ldecom</p> <p>310 049 L=1000 mm</p> <p>310 050 L=1300 mm</p> <p>310 051 L=1500 mm</p> <p>310 052 L=1600 mm</p> | <p>Stainless steel - matte LED lighting</p> <p>310 058 L=1000 mm</p> <p>310 059 L=1400 mm</p> | <p>Stainless steel - matte wood Jatoba</p> <p>SG-124 dLine L=1200 mm</p> |
|---|--|--|---|--|---|--|

| | | | | | |
|--|--|---|--|---|--|
| <p>Black matte structure</p> <p>310 041 L=1000 mm</p> <p>310 042 L=1200 mm</p> <p>310 043 L=1300 mm</p> <p>310 044 L=1400 mm</p> <p>310 045 L=1500 mm</p> <p>310 046 L=1600 mm</p> | <p>Black matte structure</p> <p>ZAE 66-S L = x</p> | <p>Black matte structure</p> <p>316 834 L=1000 mm</p> <p>316 835 L=1200 mm</p> <p>316 837 L=1400 mm</p> <p>316 838 L=1500 mm</p> <p>316 839 L=1600 mm</p> | <p>Black matte structure</p> <p>310 029 L=1000 mm</p> <p>310 030 L=1200 mm</p> <p>310 032 L=1400 mm</p> <p>310 033 L=1500 mm</p> <p>310 034 L=1600 mm</p> <p>310 035 L=1800 mm</p> | <p>Stainless steel - matte with cutout for reader Ekey</p> <p>310 053 L=1000 mm</p> <p>310 054 L=1300 mm</p> <p>310 055 L=1400 mm</p> <p>310 056 L=1500 mm</p> <p>310 057 L=1600 mm</p> | <p>Stainless steel - matte, with cutout for Ekey reader, LED lighting</p> <p>310 060 L=1000 mm</p> |
|--|--|---|--|---|--|

| | | |
|---------|---------|---------|
| | | |
| 316 205 | 316 213 | 316 214 |
| | | |
| 316 878 | 316 890 | 316 890 |

| | |
|-----------------------|-----------------------|
| | |
| 381 181 89 X 74 mm | 381 180 89 X 74 mm |

J 137 flush-mounted
Integrated handle strip - RAL color; Visible gap = 45mm
Length in mm according to request

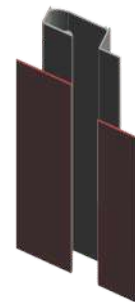

| | | | | | |
|------------------------------------|----------------|----------------|----------------|----------------|------------------------------------|
| <p>316 254 (L) 316 255 (R)</p> | <p>319 567</p> | <p>314 866</p> | <p>314 839</p> | <p>316 242</p> | <p>316 894 (L) 316 895 (R)</p> |
|------------------------------------|----------------|----------------|----------------|----------------|------------------------------------|

COLOUR CHART OF WOOD SURFACES

For wood and wood/aluminium windows and doors

The following wood species are available



Glazes (visible wood species structure)

Spruce/pine



Pine



Basic



Larch

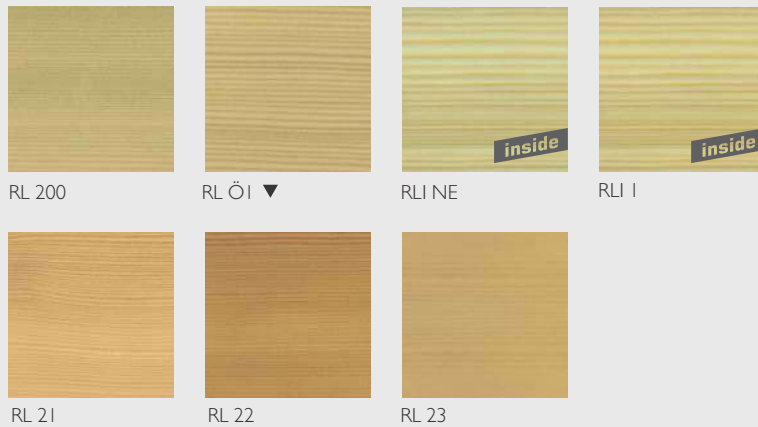

ENVIRONMENTALLY-FRIENDLY
 We use environmentally-friendly
 Water-based coatings for our
 three-layered system of
 surface treatment.

Oak



ALTHOLZ

ALTHOLZ WOOD DECOR

Available for two models: HT 100, HTA 100

Surface treatment: raw, oiled or basic



RE 200

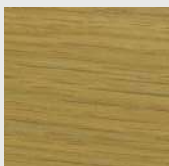

RE Ö1 ▼

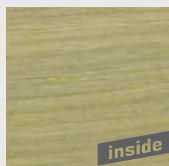

REI NE



REI I



REI 10

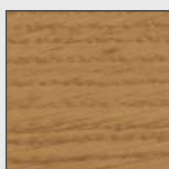

RE 21

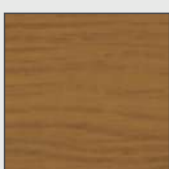

RE 22

Meranti



RM 21



RM 22



RM 23

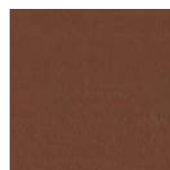

RM 24



RM 25



RM 30



RM 31

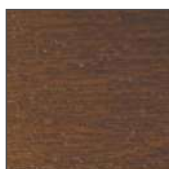

RM 32

According to the RAL colour chart

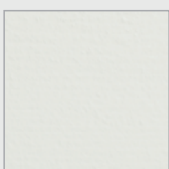

R D 21



R D 22

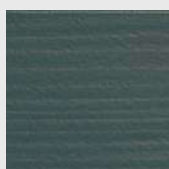

R D 25

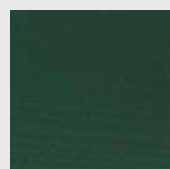

R D 44

NOTE:

▼ **OILED SURFACE** On the surface treated with oil we make no guarantees. The products like this requires at least 2x annual coating with a suitable oil, which you can buy from us.

✳ **COLORS RF/K 15, RF/K 16, RF/K 17, RF/K 26 and RK 1, RK 2, RK 4**

This shade strongly emphasizes the wood grain and is therefore more sensitive to possible color deviations, different hues and staining, which can occur due to different wood structures, restored resin bales and other manufacturing-related characteristics. Wood is a natural product, so after such a surface treatment with a more pigmented primer, the different absorption of the wood due to its unique shape and structure creates a playful combination of colours. This does not mean a reduction in the quality of the natural product wood nor that such colour differences can be a reason for a complaint about wood products.

COLOUR CHART OF ALUMINIUM SURFACES, HANDLES

Colours of aluminium for wood and wood/aluminium windows and doors

MASTER COLLECTION (feinstruktur, metallic)



Night Grey
Feinstruktur Metallic



Cast Iron
Feinstruktur Metallic



Russet Copper
Feinstruktur Metallic



Brown
Feinstruktur Metallic

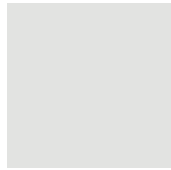

Artic Ice
Feinstruktur Metallic



Granit Nature
Feinstruktur Metallic



Volcanic Ash
Feinstruktur Metallic



Precious Sand
Feinstruktur Metallic

ANODIZING COLLECTION (matt, metallic)

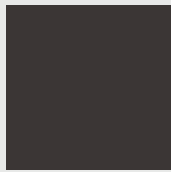

CARBON NIGHT
Matt Metallic



DARK COPPER
Matt Metallic



SIMPLY COPPER
Matt Metallic



ORIGINAL PLATINIUM
Matt Metallic



GSPED 0
Matt



GSPED 1
Matt



GSPED 4
Matt



NOBLE BRONZE
Matt Metallic

RAL FARBEN (matt, feinstruktur, metallic, glatt)

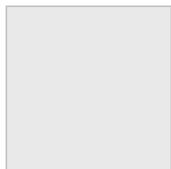

RAL 9016
Matt/ Feinstruktur



RAL 7035
Matt/ Feinstruktur



RAL 7004
Matt/ Feinstruktur



RAL 7016
Matt/ Feinstruktur

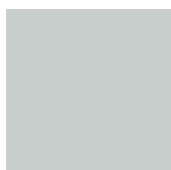

RAL 9006
Metallic glatt



RAL 9007
Metallic glatt



DB 703
Metallic glatt



DB 703
Metallic Feinstruktur

Imitation in stone



Dekor Zement hell



Dekor Beton dunkel

Imitation in wood



Dekor Altholz
(Stadelholz-1N)



Dekor Stadelholz grau

GS Stemeseder Imitation wood

IMITATION
IN WOOD

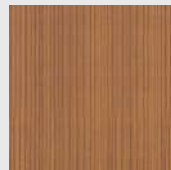

Douglas 7

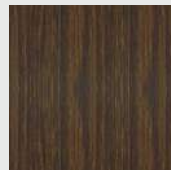

Eiche dunkel

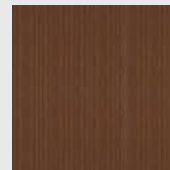

Kirsch 2

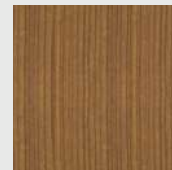

Kirsch 3

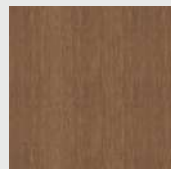

Golden Oak

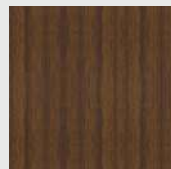

Nuss 1

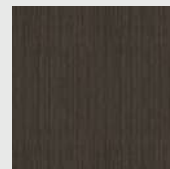

Wenge

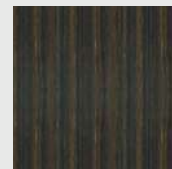

Walnuss dunkel

Inles d.d.

SI - 1310 Ribnica, Kolodvorska 22
tel.: 01 8377 100, fax: 01 8377 333

e-mail: info@inles.si



www.inles.si