

# ALUMINIUM DOORS

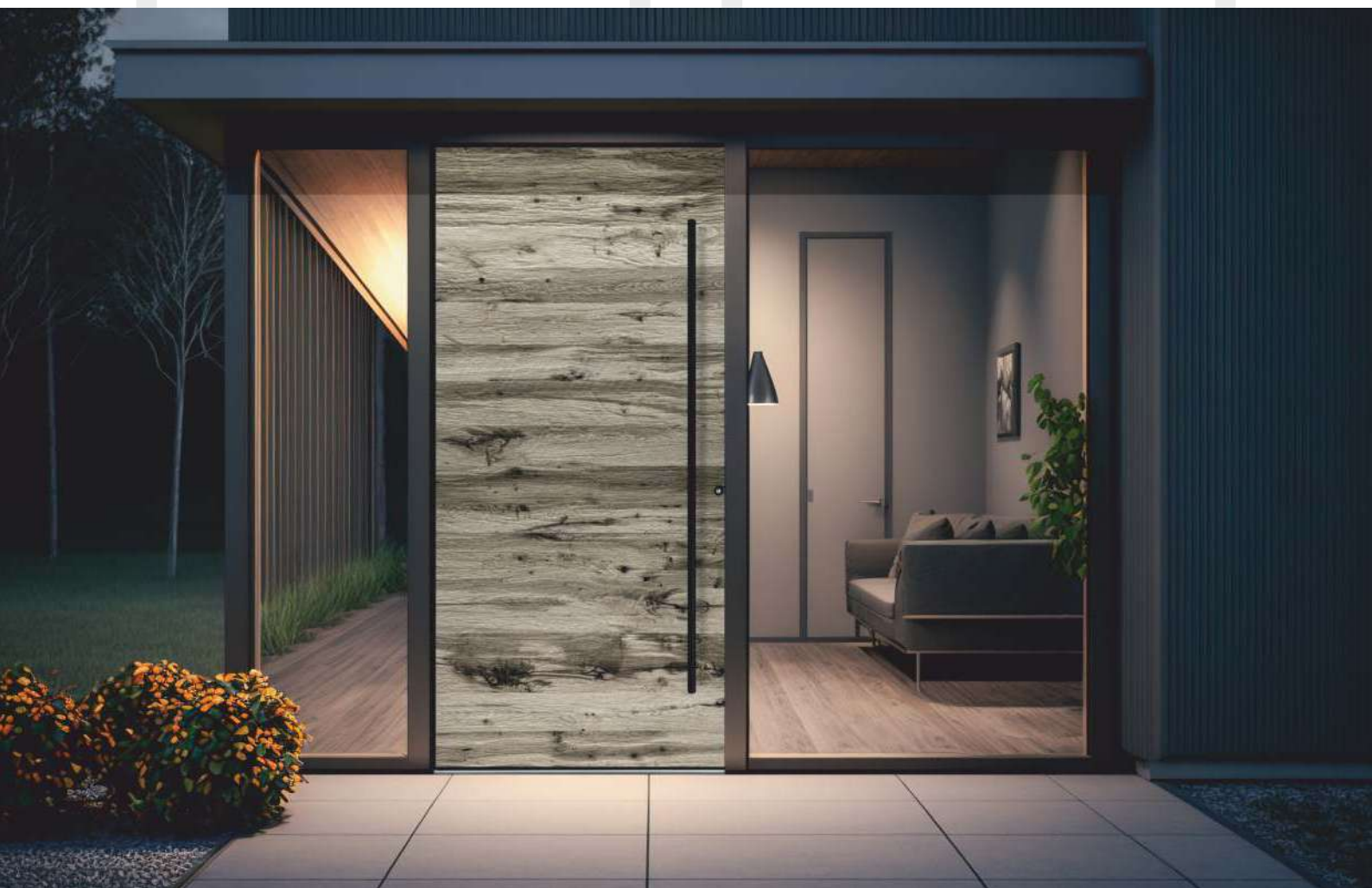

# TREND

## New Forest

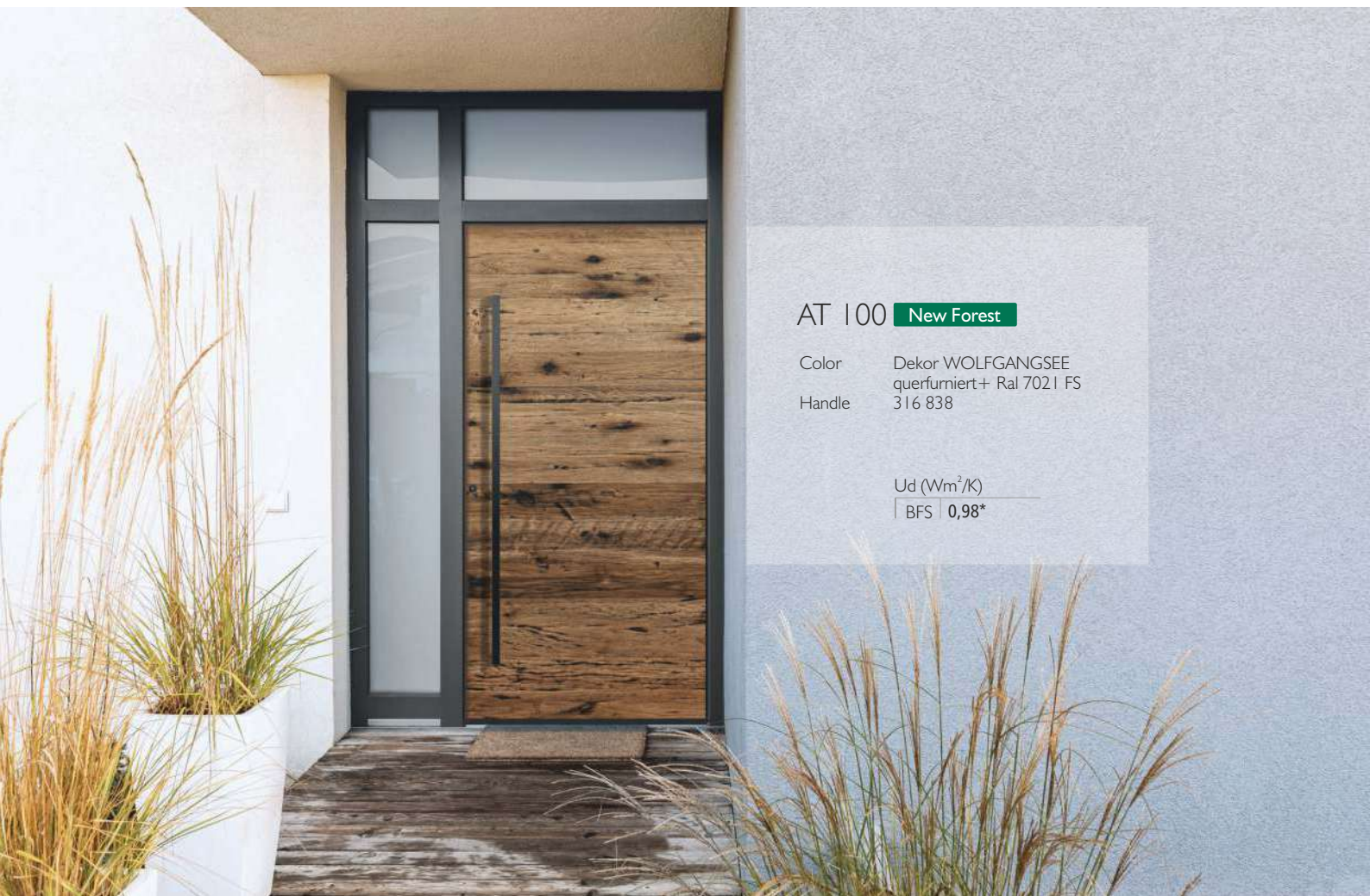

AT 100 **New Forest**

Color Dekor WOLFGANGSEE  
querfurniert+ Ral 7021 FS  
Handle 316 838

Ud (Wm<sup>2</sup>/K)  
| BFS | 0,98\*

Aluminum front doors with a veneered wood panel are available in the ADS 95AK.SI system with a double-sided, leaf-overlapping design. The exterior side of the door leaf is covered with veneer, bringing the warmth of wood and the unique grain of each door.

Available in five different veneer finishes.



AT 100 **New Forest**

Color Dekor MONDSSEE  
cross-veneered + Ral 9005 FS  
Handle 316 838

Ud (Wm<sup>2</sup>/K)  
| BFS | **0,98\***



AT 100 **New Forest**

Color Dekor TRAUNSEE  
cross-veneered + Ral 9005 FS  
Handle 316 838

Ud (Wm<sup>2</sup>/K)  
| BFS | **0,98\***

AT 100 **New Forest** /AST 100A

Color Dekor ALTAUSSEE  
cross-veneered + Ral 9005 FS  
Glass Orn. Satinato white  
Handle 316 838  
Opening on a fingerprint

Ud (Wm<sup>2</sup>/K)  
| BFS | **0,98\***

## SYSTEM ADS.SI

- ☐ Frame profile is made from 75 or 95 mm thick aluminium and has straight or curved lines.
- ☐ Casement profile is made from 85 and 75 mm thick aluminium.
- ☐ Frame and casement profiles include a core thermal insulation weatherstrip that improves their thermal performance.
- ☐ Hard PUR foam core is clad in aluminium and features superior thermal insulation performance.
- ☐ In variants where the casements are covered on both sides and have no glazing, the thermal transmittance of the doors is  $U_d = 0.84 \text{ W/m}^2\text{K}$ , while in aluminium entrance doors with cladding on one side the  $U_d$  value is  $1.2 \text{ W/m}^2\text{K}$ .



## HARDWARE

- ☐ Quality three-dimensional adjustable hinges.
- ☐ 3 or 5-point locking of the leaf.
- ☐ Various options for opening: outside opening, a fingerprint system, electrical opening etc.

## GLAZING

- ☐ You can choose from a variety of thermal and acoustic insulation and safety glass.
- ☐ A wide selection of ornaments and vitrages according to your wishes.
- ☐ Finishing the glass with various foils, glass accessories, sandblasting etc.



## SURFACE TREATMENT

- ☐ Quality and environmentally friendly powder coating surfaces.
- ☐ You can choose from a wide range of standard colours, metallic colours, imitation wood dekors and colours from RAL colour chart.

**OPENING**

inward-opening doors, exterior view



DIN left



DIN right

**TYPE OVERVIEW** view from inside

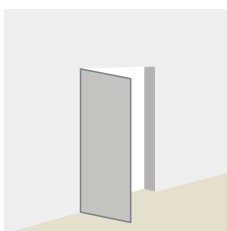

Type 01

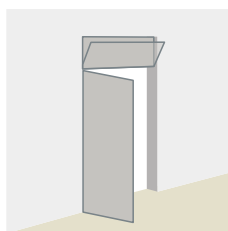

Type 02/03

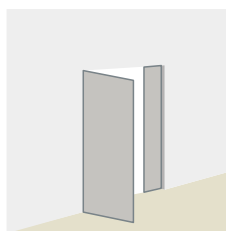

Type 04

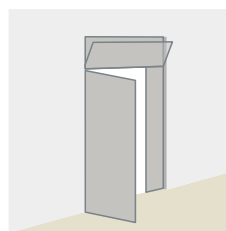

Type 05/06

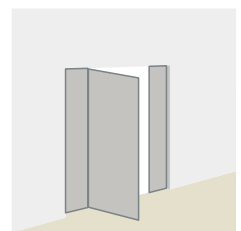

Type 07

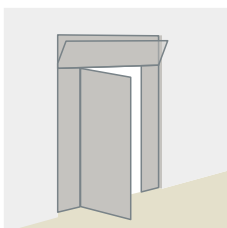

Type 08/09

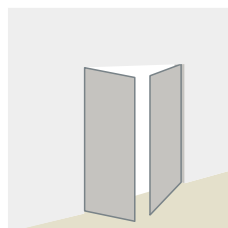

Type 21

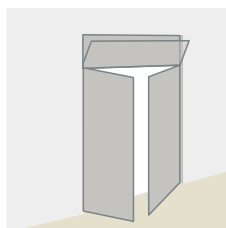

Type 22/23

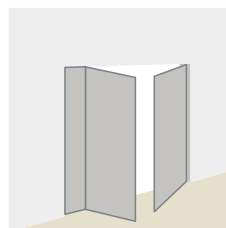

Type 24

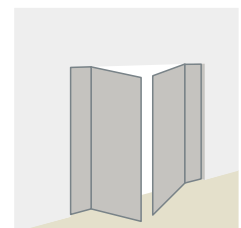

Type 25

## Aluminum entrance door **outside**

Model AT 100, system ADS 75B.SI

**flush outside**

Color: wing Dekor Altholz (Stadelholz- IN), cross-veneered  
frame: Cast Iron Fs Metallic



## Wood/Alu window **outside**

INO-HA80-MM **flush**

INO-HA80-F **flush**

Color Alu: Cast Iron Fs Metallic

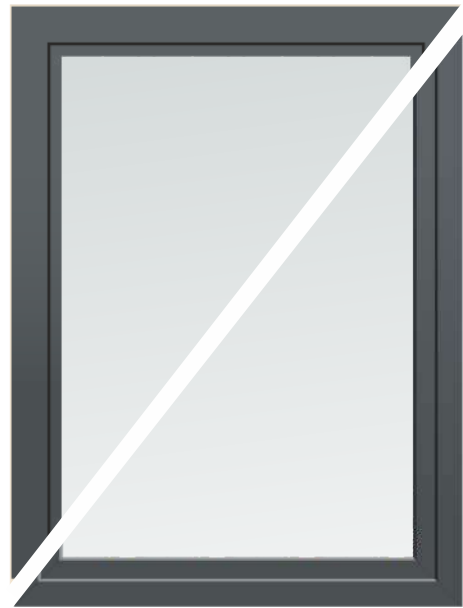

## Vinyl/ aluminium window **outside**

Living Top Alu (non-flush)

Color Alu: Cast Iron Fs Metallic

## EASY TO USE



Opening with fingerprint  
DLIne



Opening with fingerprint  
Idencom



Handle with integrated  
fingerprint dLine



Smart unilock  
Multifunktions-Keypad

### Aluminum entrance door **inside**

Model AT 100, System ADS 75B.SI

**flush inside**

Color: Cast Iron Fs Metallic

#### Wood/Alu window **inside**

INO-HA80-MM **flush**

INO-HA80-F - standard

Color: DB 703



#### Vinyl/ aluminium window **inside**

Living Top Alu (non-flush)

Color PVC: Cast Iron Fs Metallic



#### LED LIGHTING



Handle with LED lighting,  
with scratch protection  
and stainless steel application



Led-Diodes

#### DIGITAL DOOR VIEWER



with LCD screen



**ADS 95AK.SI**  
square frame

Coating of aluminum on both sides

**Ud = 0,81 W/m²K**

(Ud value calculated for a door size of 1230 × 2180 mm, without glass cut-out)

**Ud = 0,84 W/m²K**

(Ud value calculated for a door size of 1100 × 2100 mm, without glass cut-out)



**ADS 95.SI**  
round frame

triple glazing

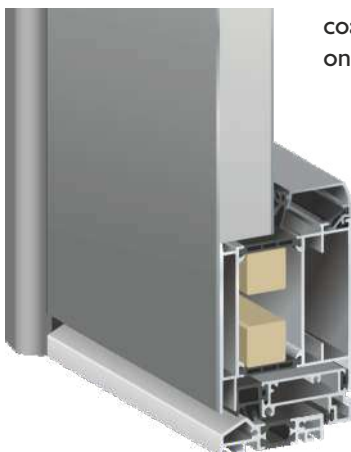

coating of aluminum  
on outer side

**Ud = 1,2 W/m²K**  
(ohne Glassausschnitt)



visible door frame  
- inside and outside

In these models the wings are visible both inside and outside. They are available in all types of doors except for the Deluxe series.



**ADS 75B.SI**

Flush on the inside  
and outside.

**Ud = 0,83 W/m<sup>2</sup>K**

(Ud value calculated for a door size of 1230 × 2180 mm, without glass cut-out)

**Ud = 0,87 W/m<sup>2</sup>K**

(Ud value calculated for a door size of 1100 × 2100 mm, without glass cut-out)

Coating of aluminum on both sides

**Ud = 0,81 W/m<sup>2</sup>K**

(Ud value calculated for a door size of 1230 × 2180 mm, without glass cut-out)

**Ud = 0,84 W/m<sup>2</sup>K**

(Ud value calculated for a door size of 1100 × 2100 mm, without glass cut-out)



**ADS 75.SI**

Flush on the outside

**GLAZING SYSTEMS**

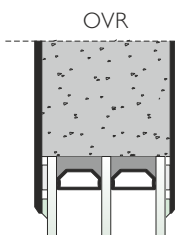

Series **TREND**

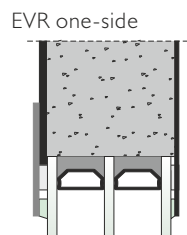

Series **DELUXE**  
(standard)

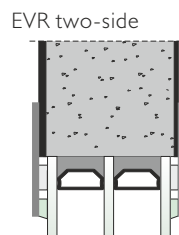

Series **DELUXE**

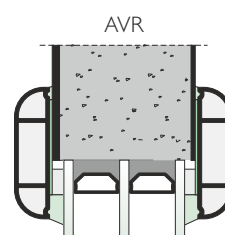

Series **MODERN, CLASSIC**

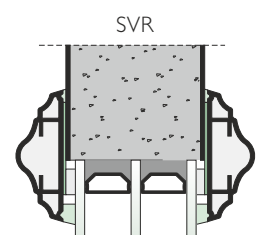

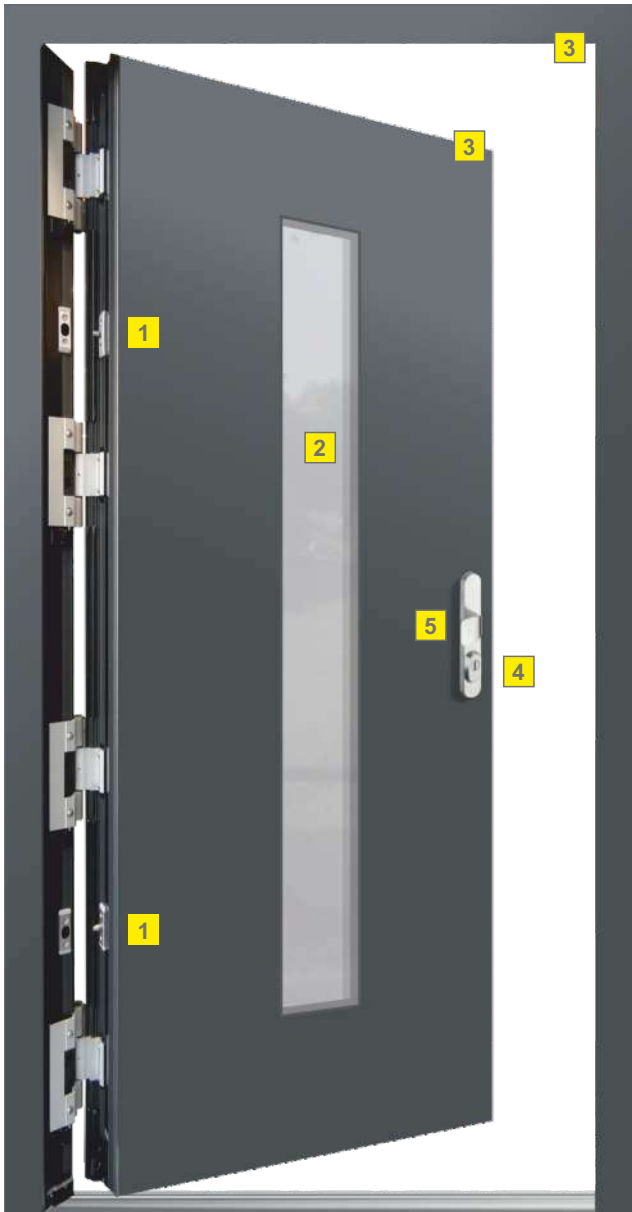

RC2 – we are happy to provide you with detailed advice on this.

In addition to the high quality standard of aluminium front door, these are equipped with a 5-point lock as standard locking.

You can safety upgrade the door with certified RC1 safety levels and RC2 and equip them for a simpler and more practical use.



## RC2 VERSION

1 SAFETY BOLT



2 SAFETY GLASS P4A



3 WING LIFT LIMITER



4 SECURITY PROFILE CYLINDER WITH ANTI-DRILL PROTECTION

5 SAFETY KNOB



**3** THREE-DIMENSIONAL  
ADJUSTABLE HINGES



Up to a door height of 2150 mm  
- 3 hinges are installed, over dim. 2151 mm  
- 4 hinges are installed (standard)

**4** THRESHOLD

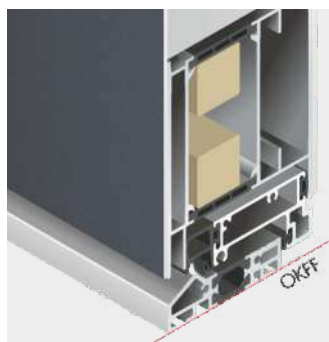

FP1 (standard)

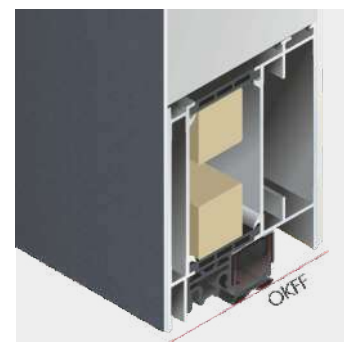

FP5

# SECURITY DOOR LOCKS



**ATVE 5**  
**5-point lock**  
 - stainless steel  
 with bolts and  
 swing hooks

**basic security  
 serial**

*mechanical multipoint  
 locking system*

*5-point security  
 through one main  
 latch, 2 bolts, and  
 2 swing hooks*



**ATVK 5**  
**5-point lock with  
 comfort function**  
 - stainless steel  
 with bolts and  
 swing hooks

- Mechanical opening of the door via handle always possible (convenience opening)
- A free-wheeling cylinder or a thumb turn cylinder is required
- Only possible in combination, except pull handle – inside handle (outside handle not possible)

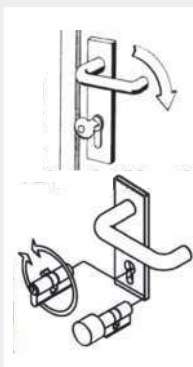

Comfort function  
 = quick opening from  
 the inside via the handle

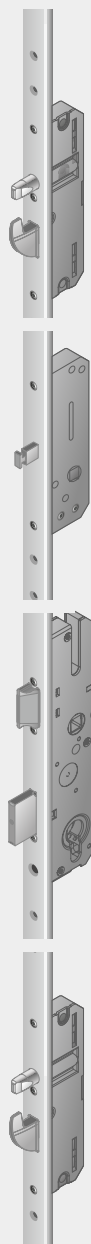

**ATVS 5**  
**5-point security lock**  
 - stainless steel  
 with bolts, swing hooks  
 and door gap restrictor

*The spring-loaded security latch ensures that the door only opens a crack, preventing any unwanted guest from squeezing between the door and frame.*

*From the inside, the security latch lock can be easily operated via a thumb turn; from the outside, it is operated with a key via the main lock.*



## ELECTRIC OPENER



## CONCEALED DOOR HINGES



Opening inwards  
 - 100° opening angle



Opening outwards  
 system ADS 75B.SI  
 - 100° opening angle

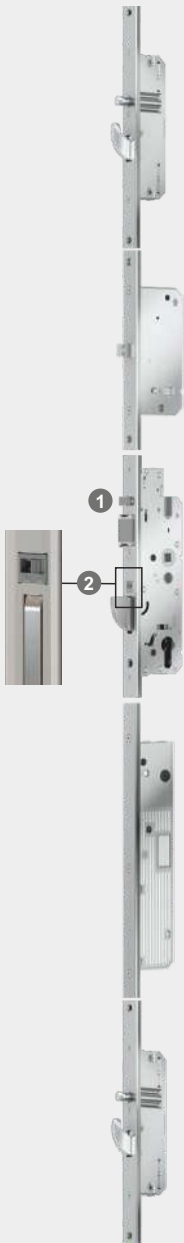

**ATVE A**  
5-point security lock  
AVTOMATIC,  
MECHANICAL

Automatic multipoint locking system with integrated self-adjustment

- 1 Always reliably secure. To ensure the door is reliably locked at all times, the automatic release latch is integrated.
- 2 Day release: Leave the house without a key. Practical for everyday situations in which you want to leave the building briefly without a key: simply deactivate the automatic function using the day-release slider and release the main lock latch on the frame part.

**ATVE A-M**  
5-point security lock  
AVTOMATIC,  
MECHANICAL  
with motorized function,  
including power supply unit

- Locking elements can be mechanically locked
- Unlocking via intercom system, biometrics, etc. (the main lock bolt must not be double-locked)



**ATVS 5EA**  
5-point lock Genius

Stainless steel, including power supply unit, with electromechanical drive, free-wheeling profile cylinder with anti-drill protection and emergency function, including 6 keys.

Attention: Only cylinders marked FZG may be used!

As soon as the door is closed, automatic locking is activated in night mode by the motor (approx. 3 seconds). All available locking elements are extended.

The door can be unlocked manually using the cylinder key or automatically via an external access control system.

When the door is fully locked, it is also possible to retract all locking elements from the inside via the handle and open the door quickly in this way.

## PROFILE CYLINDER



Profile cylinder with emergency and danger function and 6 keys (standard)



Profile cylinder with anti-drill protection and 6 keys



Free-wheeling profile cylinder with anti-drill protection and emergency function, including 6 keys

## Access control system (ATVE A-M, ATVS 5EA GENIUS)



dLine



dLine black



Smart unilock

The Smart Unilock is an innovative keypad that combines opening via mobile app, fingerprint, code, or RFID in one product.



Idencom

## Aluminum entrance door **outside**

Model AT 894, System ADS 95AK.SI

Color: Cast Iron Fs Metallic, HD Walnuss dunkel

house number- stainless steel

HOUSE NUMBER  
AS MOTIF ON GLASS



VIEWER



Brass polished / satin chrome

ROSE



Stainless steel  
(standard)      black



Weatherboard



Different systems  
mailboxes



WSE 03, Stainless steel Application



WSE 01, Stainless steel



WSE 02, Stainless steel

## Aluminum entrance door **inside**

Model AT 894, System ADS 95AK.SI

Color: Ral 9016 FS

Door closer TS 5000



Interior handles, interior rose

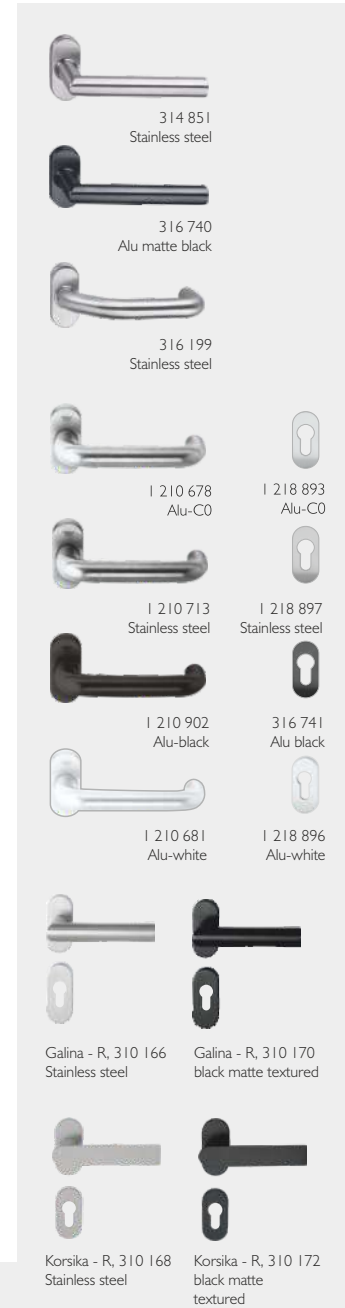

Three-part roller door hinges

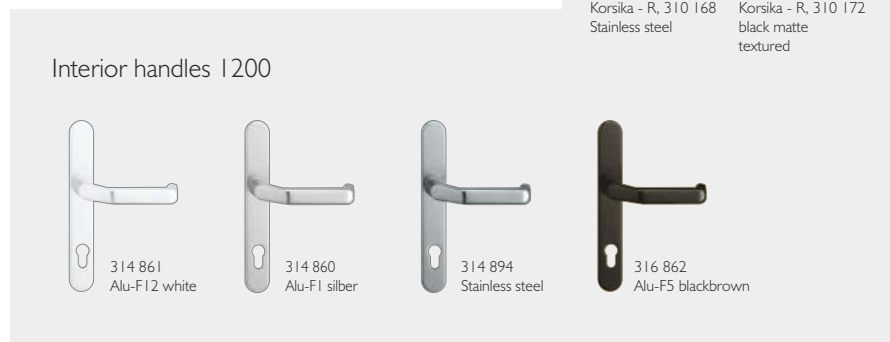

# ACCESSORIES

## HANDLE SHELLS



## EXTERIOR HANDLES



LED diodes, light color white,  
LED diode lamp, stainless steel

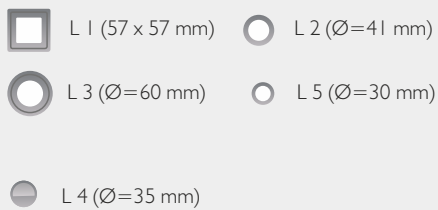

## OUTSIDE ROSETTES



Stainless steel matte  
ZAE 66R  
L=X mm



Stainless steel matte  
310 048  
L=382 mm



Stainless steel matte  
310 047  
L=382 mm

## DOOR HANDLE SET



Alu - FI silber  
314 866



Alu - FI silber  
314 863

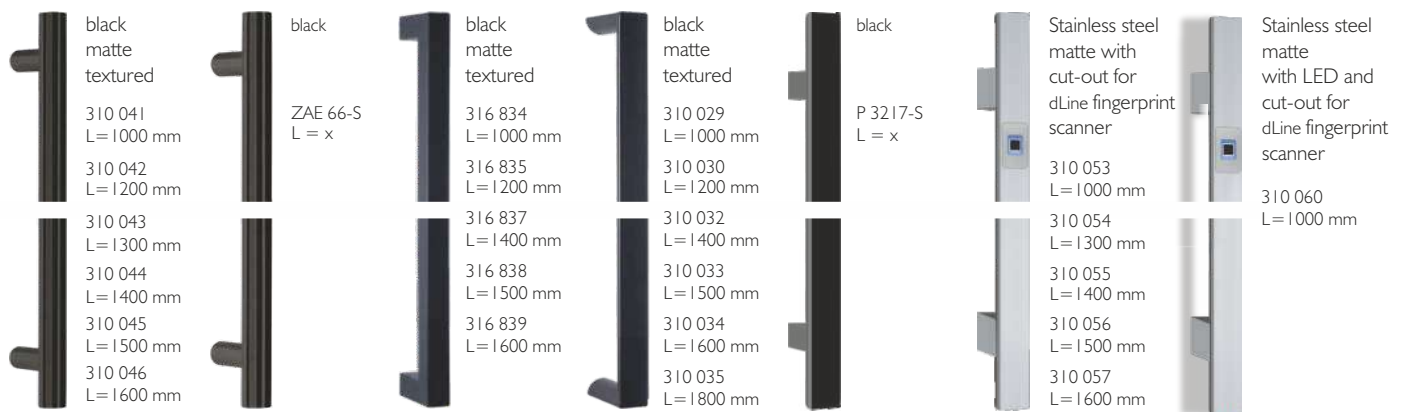
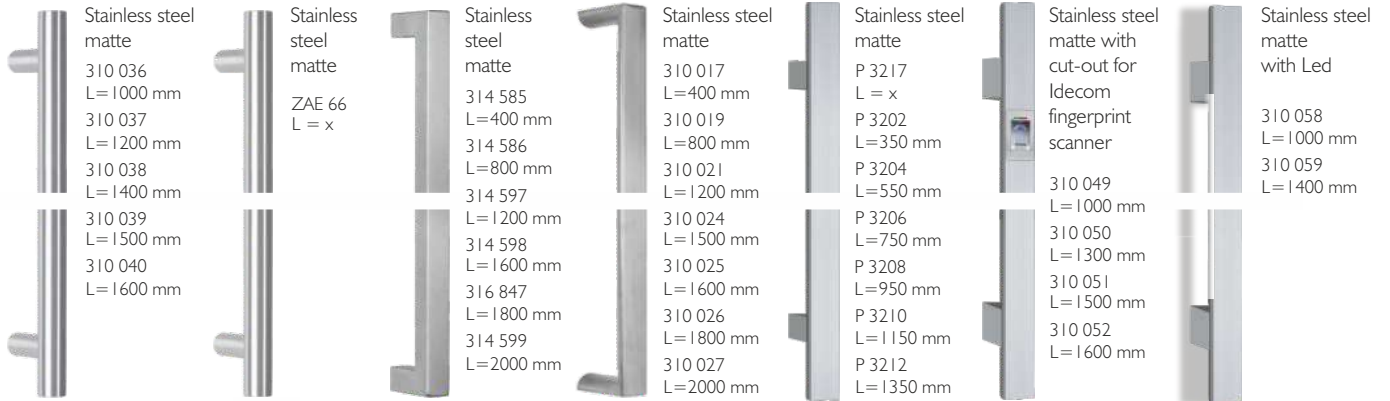

SCRATCH PROTECTION



Stainless steel 310 174	Stainless steel 310 179	Stainless steel 310 184	Stainless steel matte 316 668	Stainless steel matte 316 671	Stainless steel matte 316 662	Stainless steel matte 316 665
----------------------------	----------------------------	----------------------------	----------------------------------	----------------------------------	----------------------------------	----------------------------------

# COLORS

Varied color designs for aluminium surfaces

## MASTER COLLECTION textured, metallic



Iceberg Blue  
Feinstruktur Metallic



Rumbling Sky  
Feinstruktur Metallic



Night Grey  
Feinstruktur Metallic



Cast Iron  
Feinstruktur Metallic



Russet Copper  
Feinstruktur Metallic



Brown  
Feinstruktur Metallic

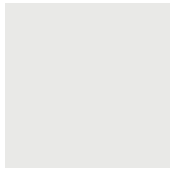

Arctic Ice  
Feinstruktur Metallic



Precious Sand  
Feinstruktur Metallic



Verdigris  
Feinstruktur Metallic



Granit Nature  
Feinstruktur Metallic



Volcanic Ash  
Feinstruktur Metallic



Elves Bench  
Feinstruktur Metallic

## ANODIZING COLLECTION matte, metallic

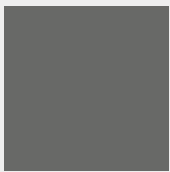

ORIGINAL PLATINIUM  
matte Metallic



SILVER DREAM  
matte Metallic

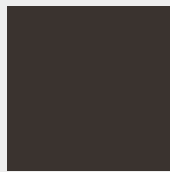

CARBON NIGHT  
matte Metallic



DARK COPPER  
matte Metallic

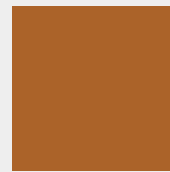

SIMPLY COPPER  
matte Metallic

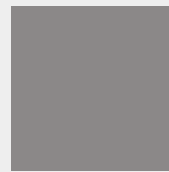

GREY BD  
matte Metallic

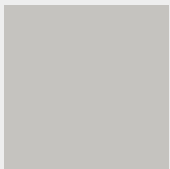

GSPED 0  
matte



GSPED 1  
matte

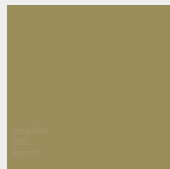

GSPED 2  
matte



GSPED 3  
matte

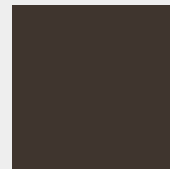

GSPED 4  
matte



NOBLE BRONZE  
matte Metallic

## RAL Colors, matte, textured, smooth, metallic

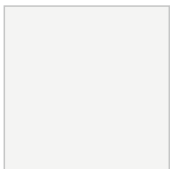

RAL 9016  
Feinstruktur

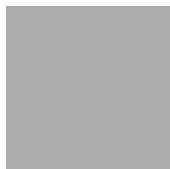

RAL 7040  
Feinstruktur

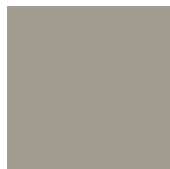

RAL 7039  
Feinstruktur



RAL 7012  
Feinstruktur



RAL 7015  
Feinstruktur



RAL 7016  
Feinstruktur

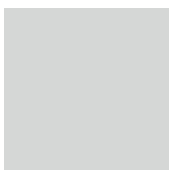

RAL 9006  
Metallic glatt



RAL 9007  
Metallic Feinstruktur



DB 703  
Metallic Feinstruktur



RAL 7021  
Feinstruktur



RAL 9005  
Feinstruktur



RAL 8019  
Feinstruktur

DECOR - APPEARANCE OF STONE



Dekor Concrete  
Beton optik



Dekor Beton dunkel

WOOD DEKOR



Dekor Altholz  
(Stadelholz-1N)

DECOR EMBOSSED OVERLAY - SERIE TREND AT New Forest



Dekor ATTERSEE



Dekor  
WOLFGANGSEE



Dekor TRAUNSEE

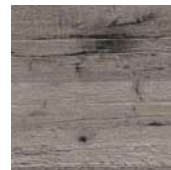

Dekor MONDSSEE



Dekor ALTAUSSEE

WOOD DEKOR (struktur)

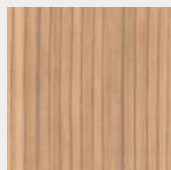

Douglas 6

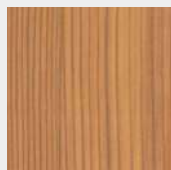

Douglas 7

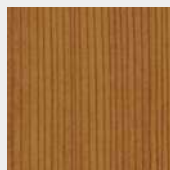

Douglas 2

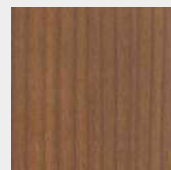

Kirsch 2

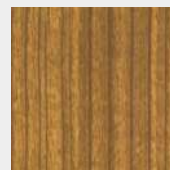

Kirsch 3

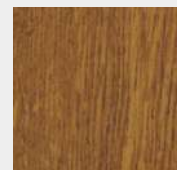

Golden Oak



Eiche 2

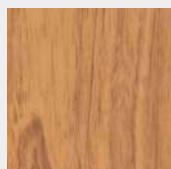

Eiche 4



Eiche dunkel

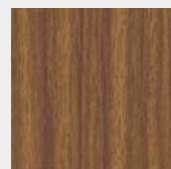

Nuss 1

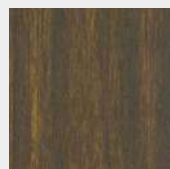

Walnuss dunkel

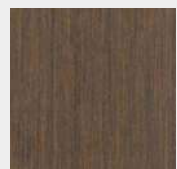

Wenge

WOOD DEKOR - Series REFINED



Nussbaum FS

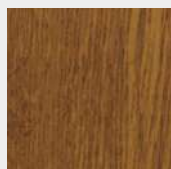

Golden Eiche FS



Helle Eiche



Dunkel Eiche

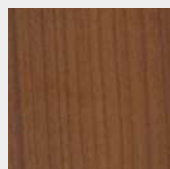

Kirsche

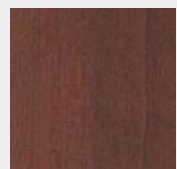

Mahagoni

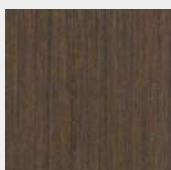

Wenge

ORNAMENTAL GLASS



Kathedral Klein. white



Chinchilla white

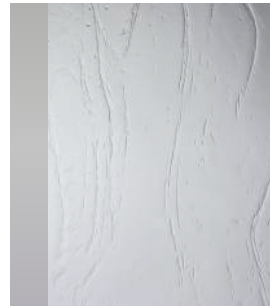

Gothic white



Altdeutsch K white

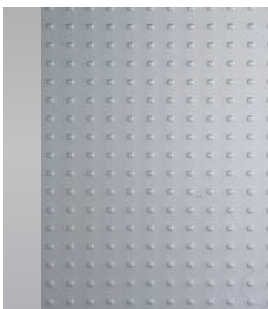

Mastercarre white



Masterligne white

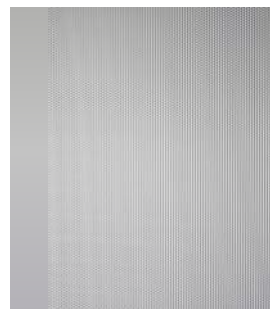

Masterpoint white



Satinato white

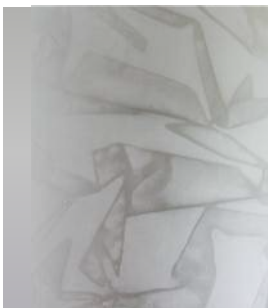

Silk white

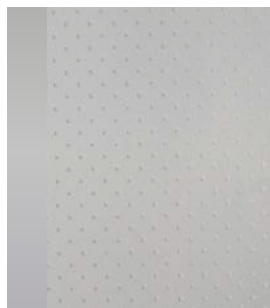

Pave white

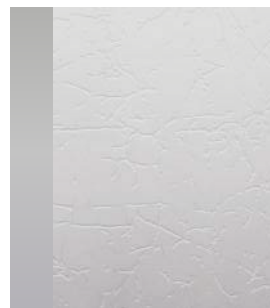

Uadi white

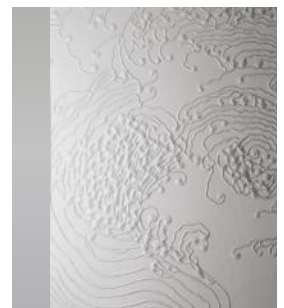

Nebulosa white

Thermal insulating glass

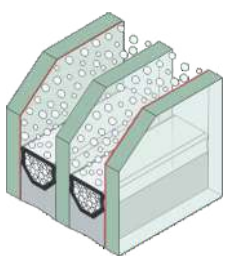

three-layer

Sandblasted glass

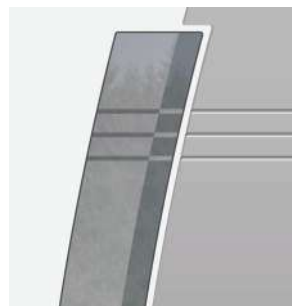

REFINED  
AR



Triumph - page 7



Canary/ AST 100A - page 6



Levent - page 7

TREND  
New Forest  
AT



AT 100 **NF** Attersee



AT 100 **NF** Wolfgangsee  
- page 8



AT 100 **NF** Mondsee  
- page 9



AT 100 **NF** Traunsee  
- page 9



AT 100/ AST 100A **NF** Altausee  
- page 9

TREND  
AT



AT 100A/ AST 100A - page 21



AT 101 - page 21



AT 102 - page 21



AT 100 - page 11



AT 121 - page 15



AT 131 - page 12



AT 153A - page 31



AT 255 - page 31



AT 264 - page 17

# OVERVIEW OF MODELS



AT 264A/AST 100A - page 13



AT 265/AST 100A - page 12



AT 265A - page 17



AT 266 - page 13



AT 266A - page 13



AT 267 - page 29



AT 801B - page 18



AT 810/AST 100A - page 15



AT 843/AST 100A - page 29



AT 862A/AST 100A - page 18



AT 863A/AST 100A - page 26



AT 863B - page 26



AT 863C - page 27



AT 864/AST 100A - page 28



AT 867 - page 20



AT 875A - page 29



AT 883/AST 100A - page 31



AT 887 - page 30



AT 887B - page 30



AT 891A - page 20



AT 894 - page 11



AT 904 - page 28



AT 906 - page 19



AT 906A - page 19



AT 907 - page 15



AT 909/AST 100A - page 14



AT 919 - page 14



AT 924A/AST 100A - page 23



AT 934 - page 25



AT 941A/AST 100A - page 19



AT 943 - page 27



AT 944 - page 22



AT 945A - page 22



AT 946A - page 23



AT 946B - page 23



AT 947/AST 100A - page 27



AT 948/AST 100A - page 25

DELUXE  
**AD**



AD 801A - page 35



AD 801A/AST 100A - page 35



AD 801B - page 33



AD 843A - page 33

# OVERVIEW OF MODELS

## MODERN AM



AD 863D - page 35



AD 945/ AST 100A - page 34



AD 945 - page 34



AM 132A - page 38



AM 132A - page 38



AM 131 - page 39



AM 134B - page 37



AM 156 - page 37



AM 170 - page 39



AM 170/ AST 100A - page 39

## CLASSIC AC



AC 182A - page 42



AC 183 - page 43



AC 183 - page 43



AC 185/ AST 185 - page 43



AC 190A/ AST 190 - page 45



AC 191/ AST 191 - page 44



AC 194A - page 44



AC 195A - page 42



AC 203A - page 41



AC 207- page 41



AC 209A - page 45



AC 209 - page 45

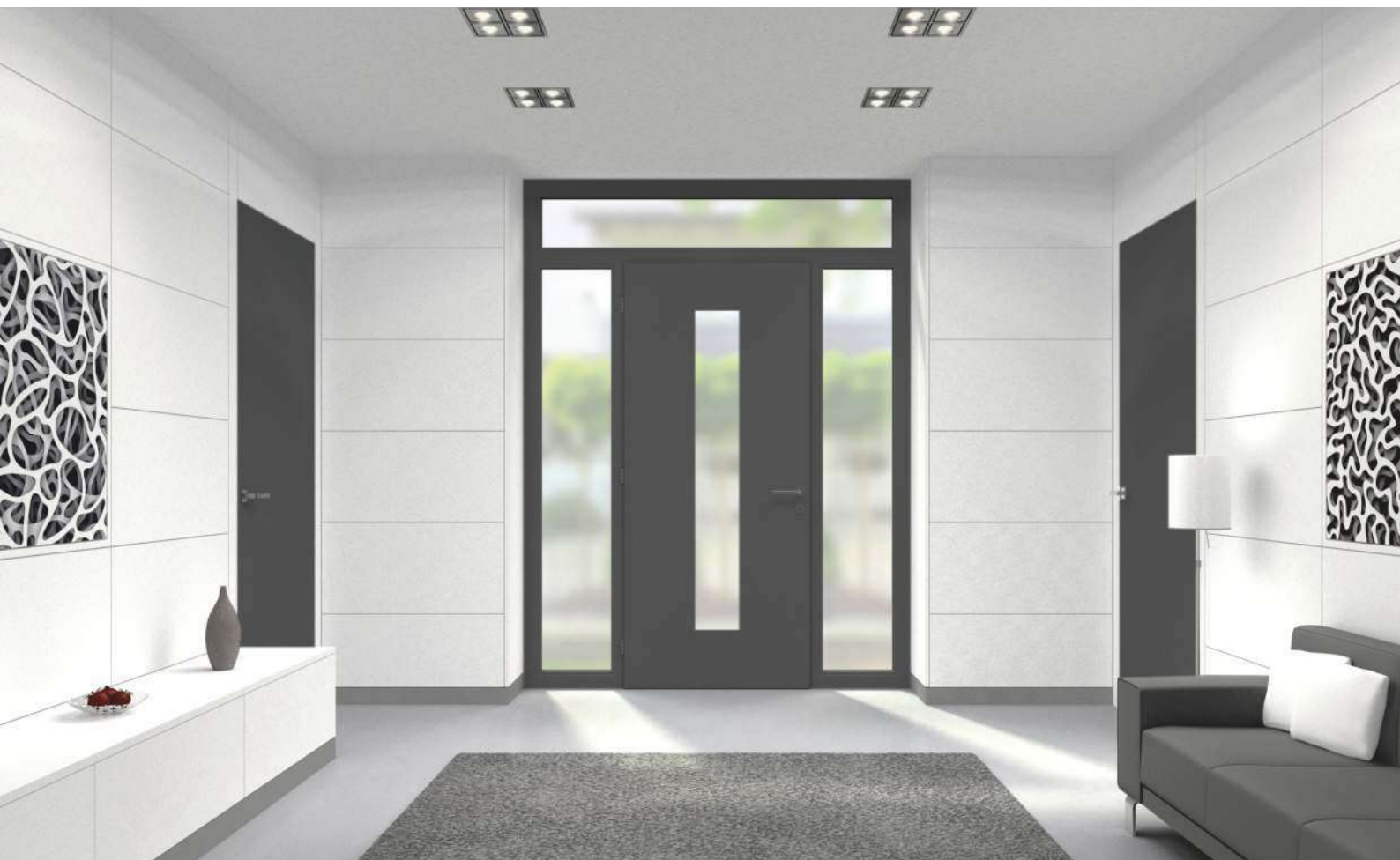

Due to printing-related factors, color deviations may occur between the images shown in this brochure and the original products..

**Inles** d.d.

SI - 1310 Ribnica, Kolodvorska 22  
SLOVENIA

tel.: +386 1 8377 100

e-mail: [info@inles.si](mailto:info@inles.si)



**[www.inles.net](http://www.inles.net)**